



# The Sea Pines Forest Preserve

## "Our Natural Treasure"

### Map Legend

#### HABITATS:

- FOREST
- FRESHWATER WETLAND
- WARNER W. PLAHS WILDFLOWER FIELD
- LAKE/POND

#### FACILITIES:

- LEISURE TRAIL
- VEHICULAR TRAIL
- WALKING TRAIL
- OBSERVATION DECK/DOCK
- WETLAND BOARDWALK
- PICNIC TABLES
- WATER/ RESTROOMS
- CSA ADMIN/ SECURITY

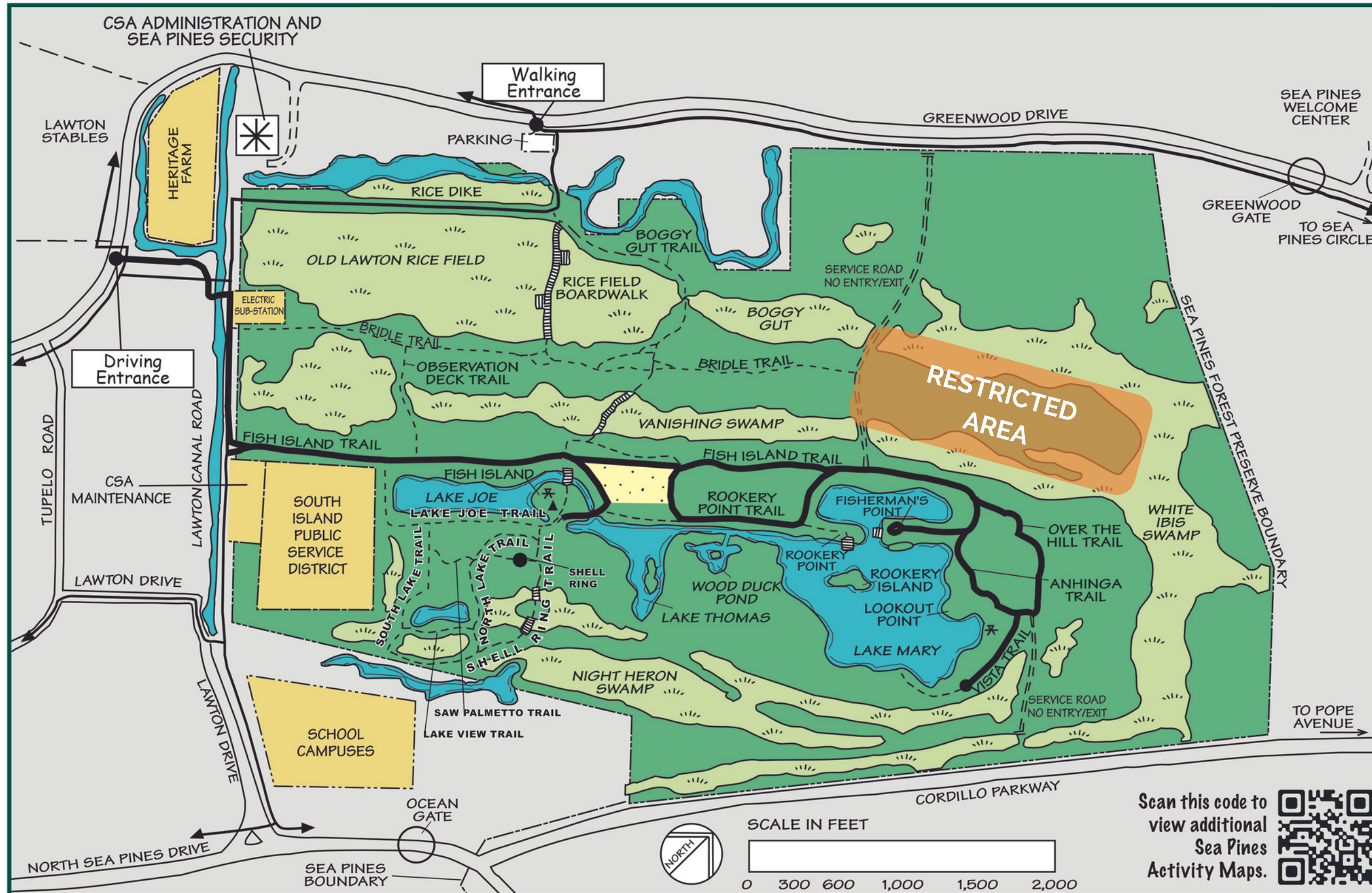

### IN CASE OF EMERGENCY

For a fire or medical emergency dial 911

For all other emergencies call  
Sea Pines Security @ 843-671-7170

The road / trail intersections and attractions in the Forest Preserve are uniquely numbered. If possible during an emergency, describe your location by reporting the number that is closest to you.

Scan this code to view additional Sea Pines Activity Maps.

