



# 2017 Sea Pines CSA Community Survey

## Traffic related need of the Community

Community Service Association (CSA)  
&  
Lowcountry and Resort Islands Tourism Institute

Nancy Hritz, PhD  
John Salazar, PhD  
Dipl.-Soz. Anton Abraham

# Sea Pines CSA Community Survey 2017

2838

Total Responses

---

**Q1: This survey is about traffic related issues in the area of Greenwood Drive and Ocean Gate near Sea Pines Plantation. Do you feel you have the knowledge to answer traffic related questions concerning one or both of these areas?**

Answered: 2,838 Skipped: 0

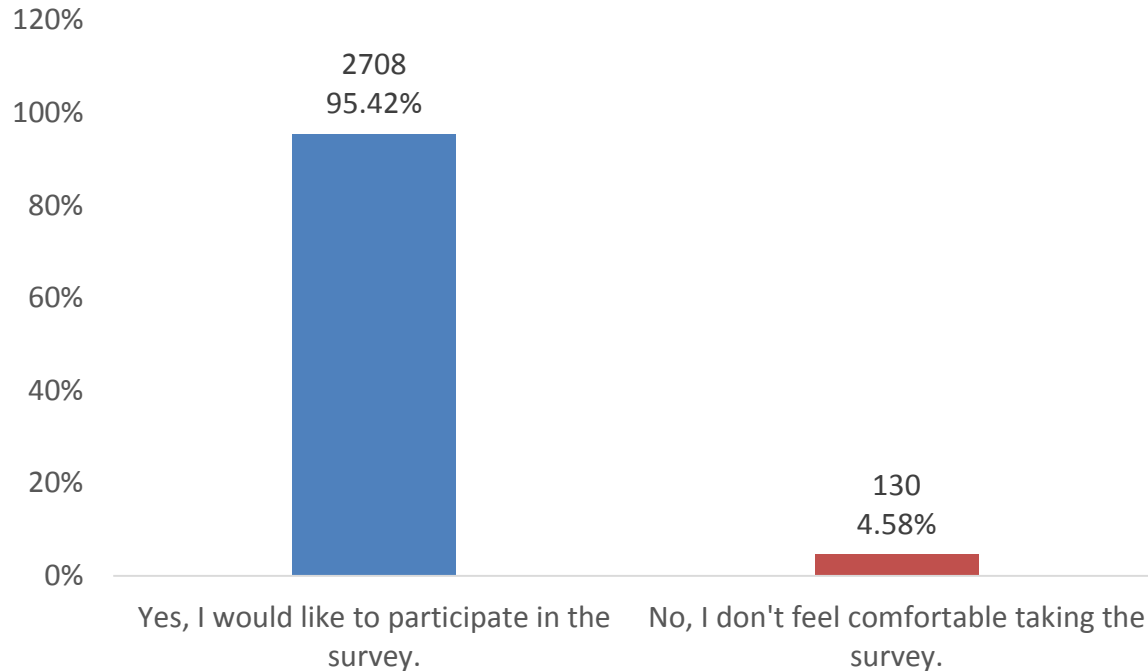

## Q2: Do you feel you have the knowledge to answer traffic related questions about the Greenwood Gate area of Sea Pines Plantation?

Answered: 2,712 Skipped: 126

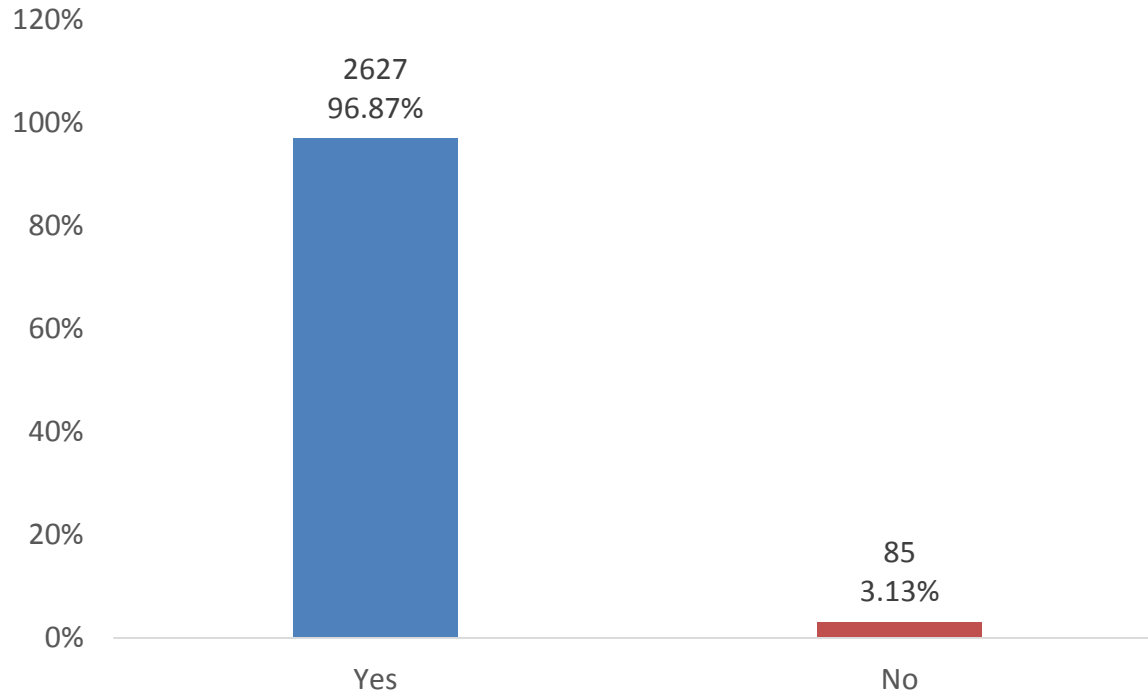

### Q3: Do you feel you have the knowledge to answer traffic related questions about the Ocean Gate area of Sea Pines Plantation?

Answered: 84 Skipped: 2,754

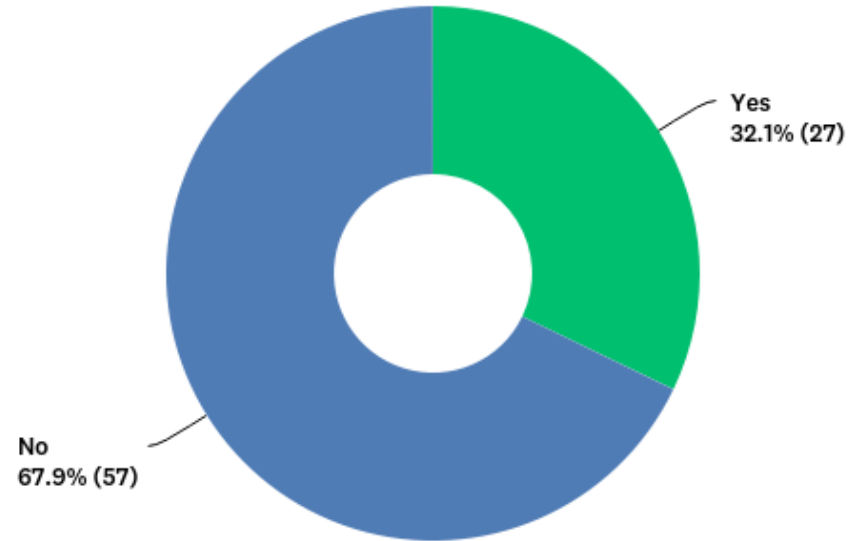

## Q4: How do you primarily use your property? (Please choose all that apply.)

Answered: 2,656 Skipped: 182

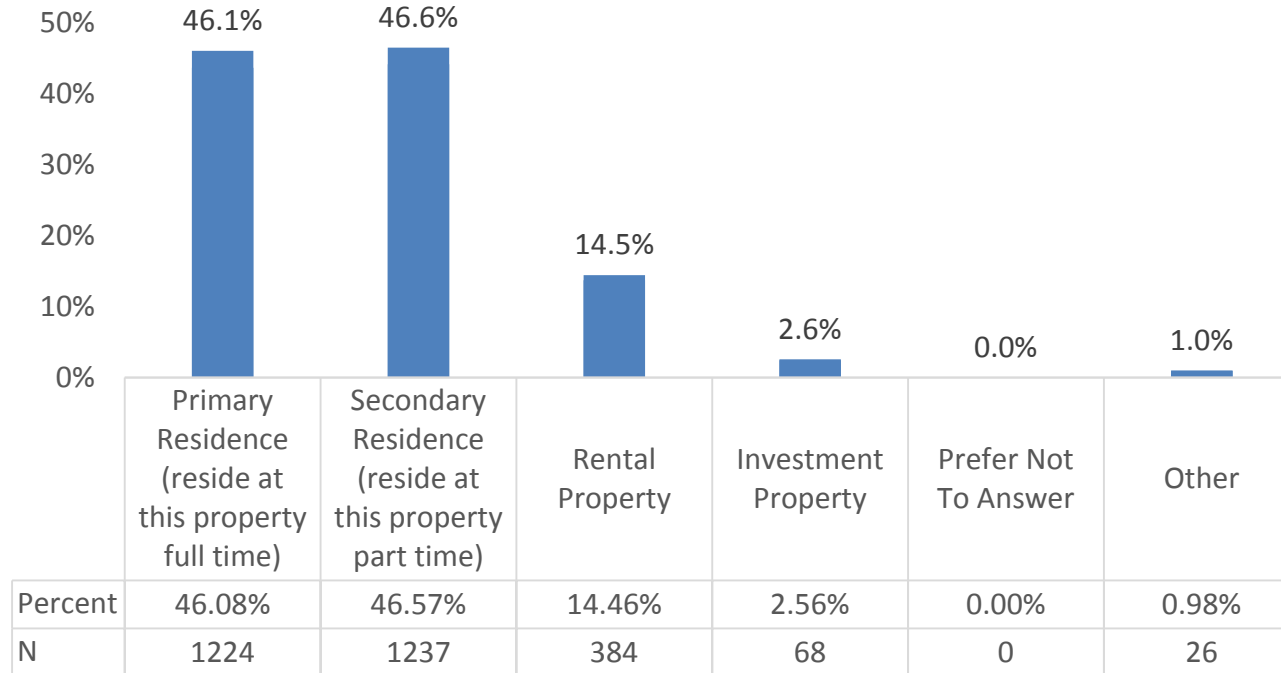

## Q5: Which months are you generally in residence in Sea Pines? Please choose all that apply.

Answered: 2,647 Skipped: 191

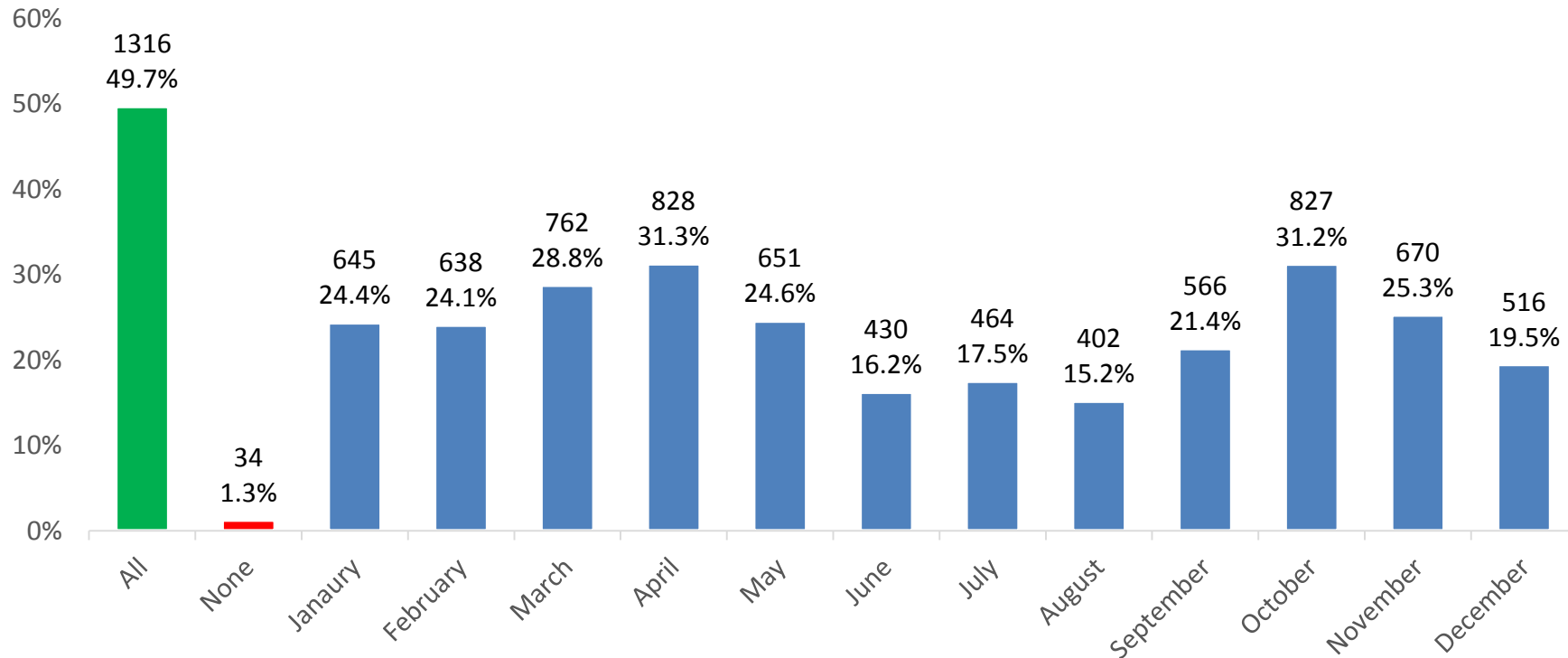



**Q6: Please provide the street name of your primary property located in Sea Pines.**

Answered: 2,621   Skipped: 217



## Q7: Please estimate how often you use the Greenwood Gate?

Answered: 2,621 Skipped: 217

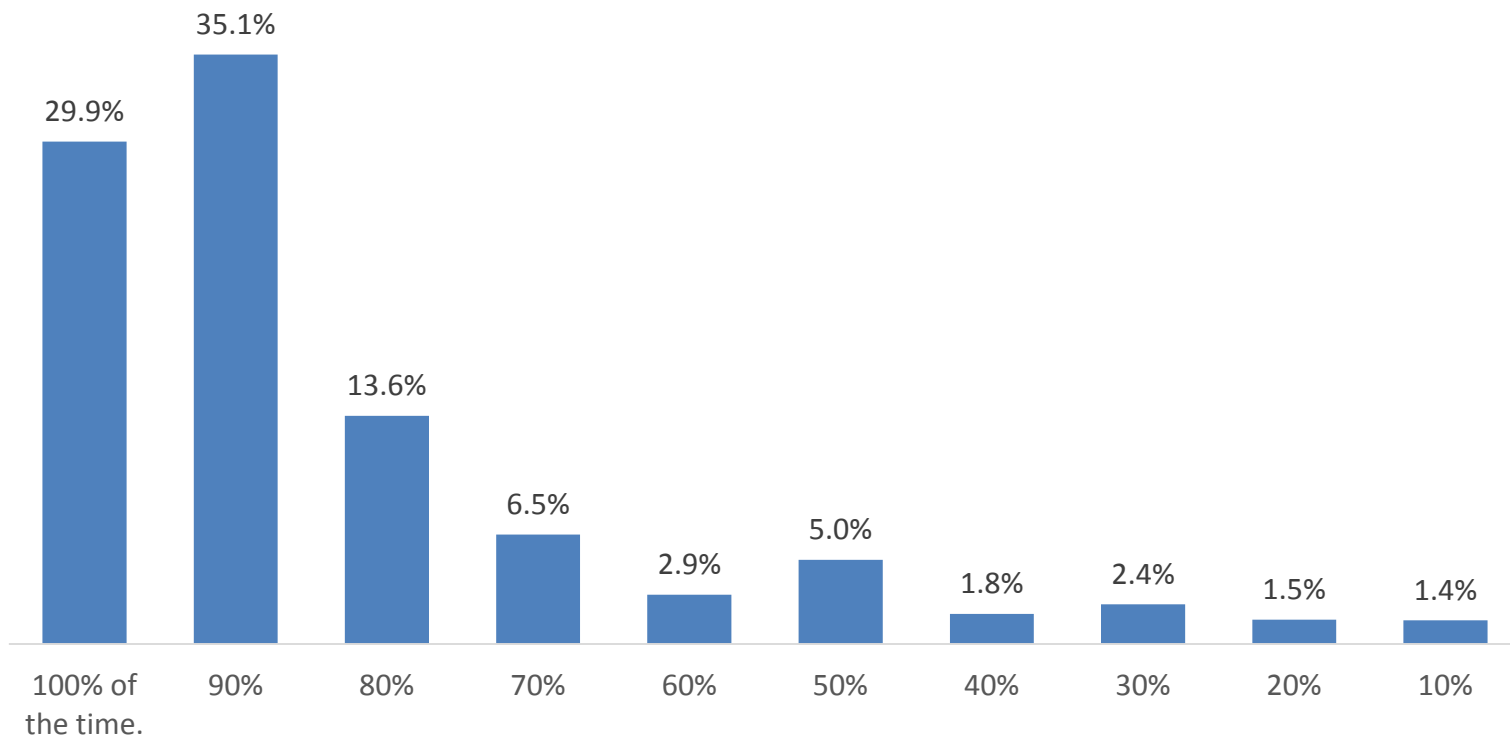

**Q8: Please indicate your personal level of concern for the following traffic situations related to your inbound drive from Sea Pines Circle to the Greenwood Gate.**

Answered: 2,622 Skipped: 216

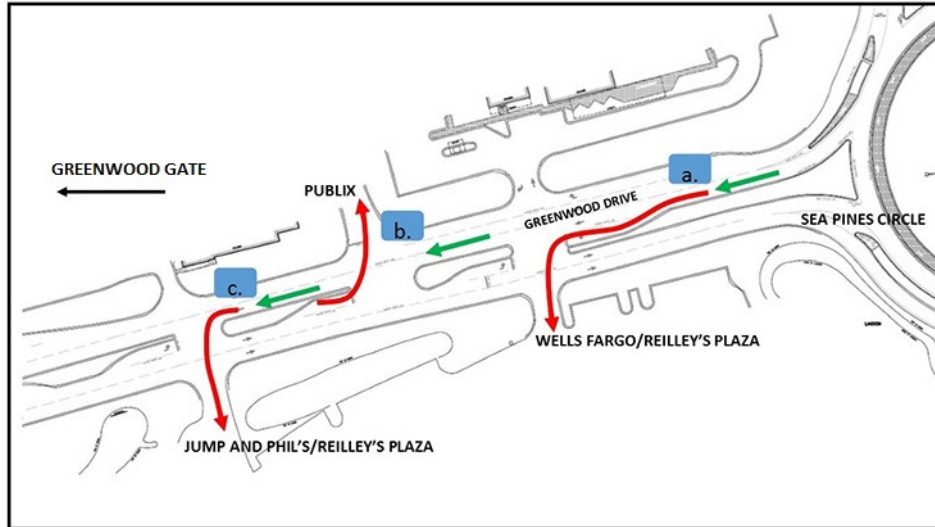

## Q8: Please indicate your personal level of concern for the following traffic situations related to your inbound drive from Sea Pines Circle to the Greenwood Gate.

Answered: 2,622 Skipped: 216

	Extremely concerned	Moderately concerned	Somewhat concerned	Slightly concerned	Not at all concerned	Total	Weighted Average
a. Vehicles in front of you turning left into Wells Fargo/Reilley's Plaza (Note- There is a turn lane here.)	14.6%	21.2%	19.9%	23.4%	20.9%	2609	2.85
b. Outbound vehicles turning left (across your lane of travel) into Publix	16.1%	27.9%	21.1%	20.7%	14.2%	2608	3.11
c. Vehicles in front of you turning left into Jump and Phil's/Reilley's Plaza (Note- There is NOT a turn lane here.)	27.2%	30.1%	18.1%	16.5%	8.1%	2611	3.52
						Answered	2622
						Skipped	216

## Q8: Please indicate your personal level of concern for the following traffic situations related to your inbound drive from Sea Pines Circle to the Greenwood Gate.

Answered: 2,622 Skipped: 216

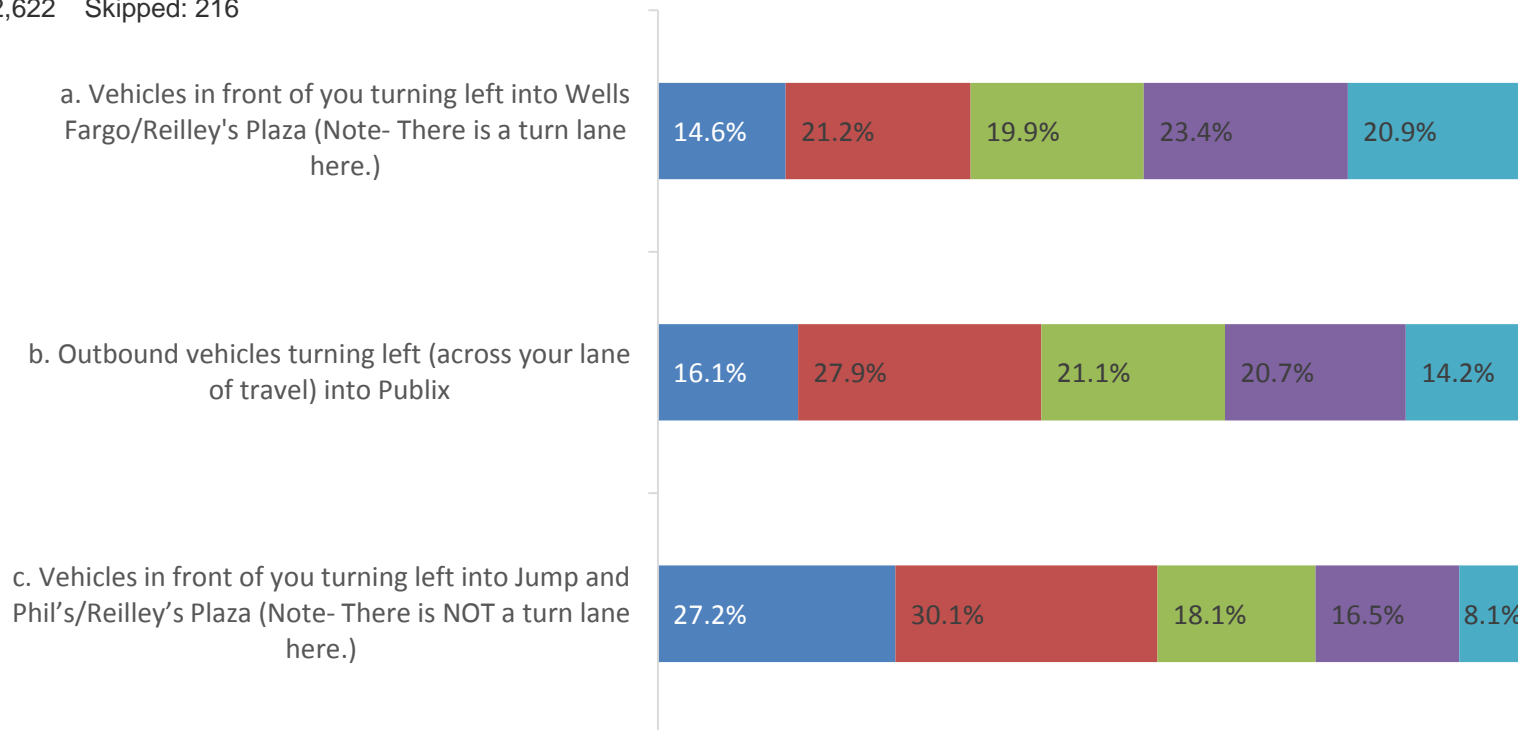

**Q9: Please continue to indicate your personal level of concern for the following traffic situations related to your inbound drive from Sea Pines Circle to the Greenwood Gate.**

Answered: 2,622 Skipped: 216

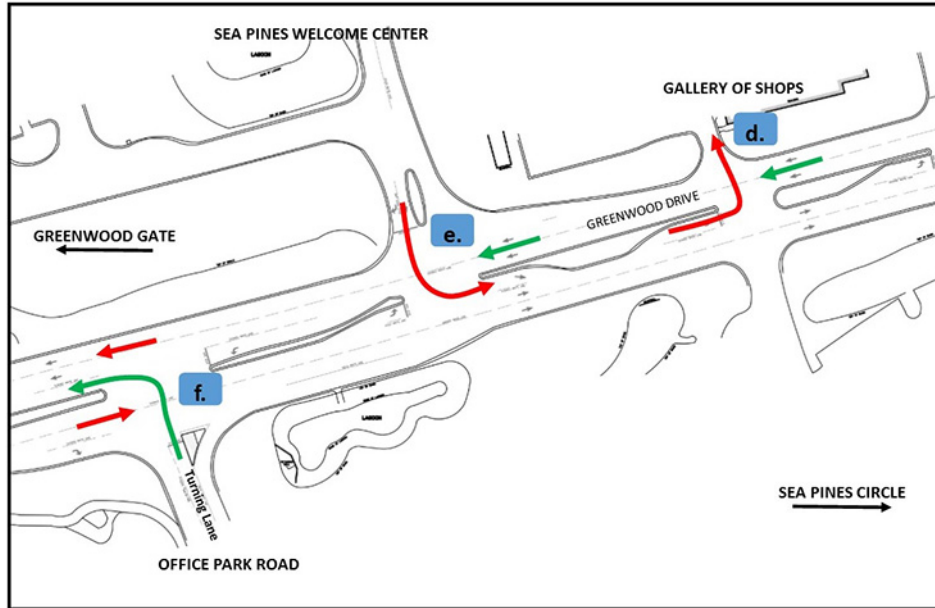

## Q9: Please continue to indicate your personal level of concern for the following traffic situations related to your inbound drive from Sea Pines Circle to the Greenwood Gate.

Answered: 2,622 Skipped: 216

	Extremely concerned	Moderately concerned	Somewhat concerned	Slightly concerned	Not at all concerned	Total	Weighted Average
d. Vehicles turning left (across your lane of travel) into the old Gallery of Shops parking lot	11.4%	23.5%	22.0%	25.7%	17.3%	2609	2.86
e. Vehicles turning left (across your lane of travel) when they are exiting the Welcome	17.3%	26.7%	21.4%	20.8%	13.8%	2610	3.13
f. Difficulty turning left out of Office Park Road onto Greenwood Drive	61.0%	23.2%	8.2%	4.5%	3.2%	2621	4.34
						Answered	2622
						Skipped	216

## Q9: Please continue to indicate your personal level of concern for the following traffic situations related to your inbound drive from Sea Pines Circle to the Greenwood Gate.

Answered: 2,622 Skipped: 216

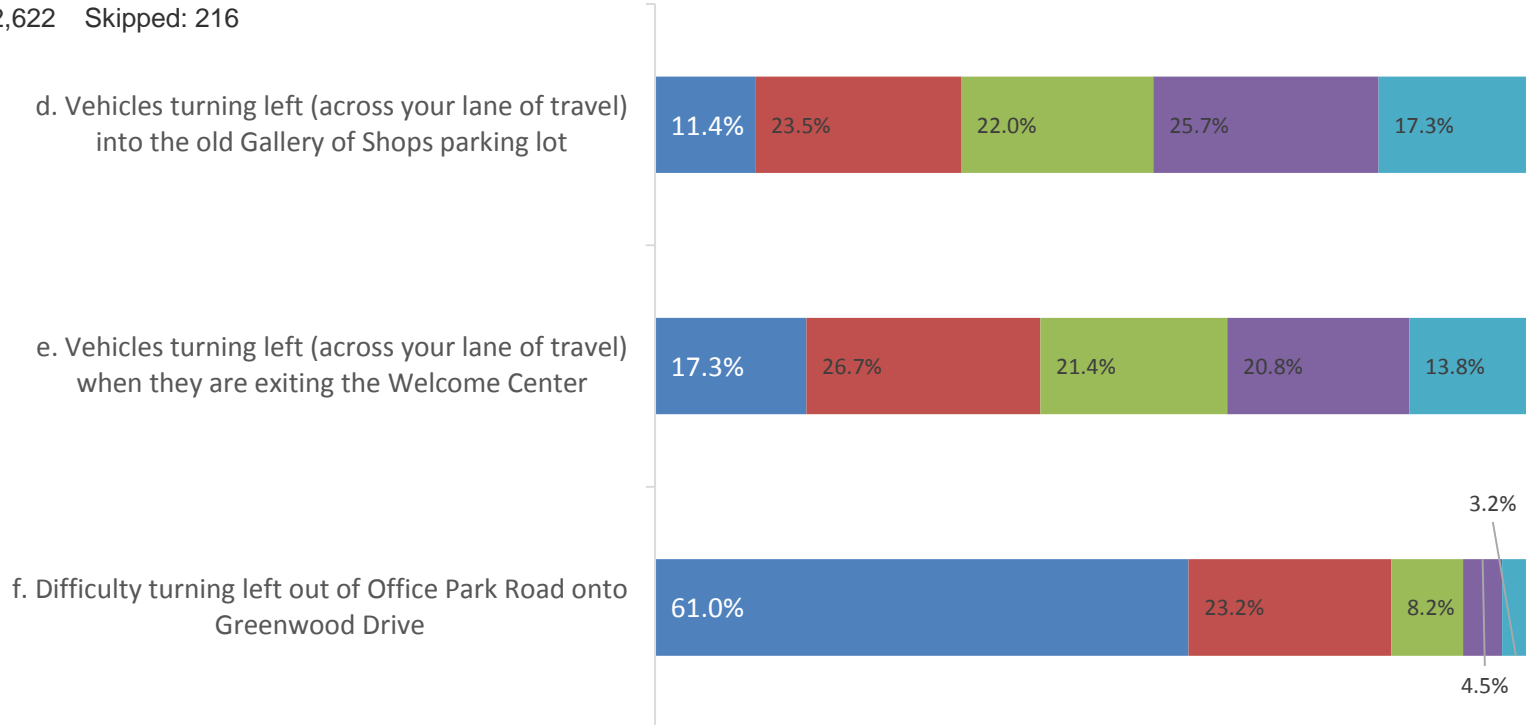



**Q10: Please continue to indicate your personal level of concern for the following traffic situations related to your inbound drive from Sea Pines Circle to the Greenwood Gate.**

Answered: 2,621   Skipped: 217

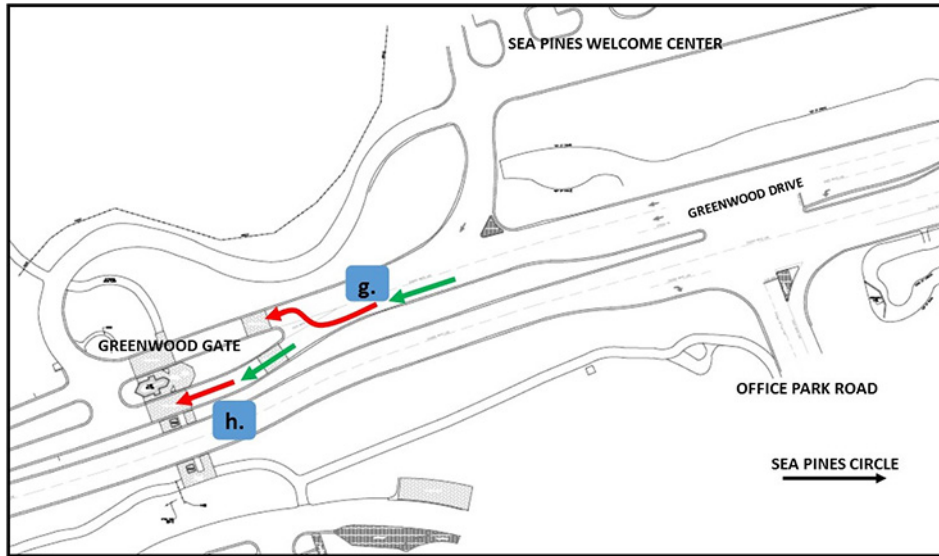

## Q10: Please continue to indicate your personal level of concern for the following traffic situations related to your inbound drive from Sea Pines Circle to the Greenwood Gate.

Answered: 2,621 Skipped: 217

	Extremely concerned	Moderately concerned	Somewhat concerned	Slightly concerned	Not at all concerned	Total	Weighted Average
g. Vehicles stopping or slowing in the left lane while attempting to merge into the right lane	39.9%	33.2%	14.8%	9.2%	2.9%	2614	3.98
h. Vehicles stopping in the left lane to purchase pass/get information/turn around	64.2%	21.5%	6.9%	5.0%	2.5%	2615	4.4
						Answered	2621
						Skipped	217

## Q10: Please continue to indicate your personal level of concern for the following traffic situations related to your inbound drive from Sea Pines Circle to the Greenwood Gate.

Answered: 2,621 Skipped: 217

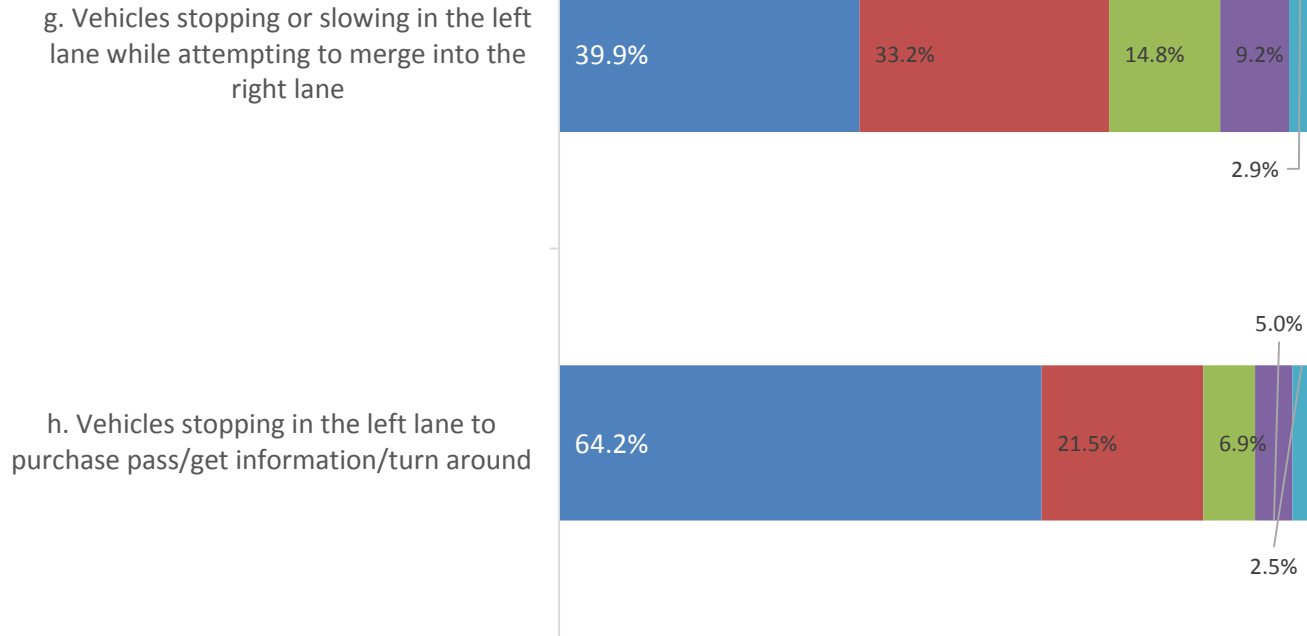

**Q11: Please continue to indicate your personal level of concern for the following traffic situations related to your inbound drive from Sea Pines Circle through the Greenwood Gate.**

Answered: 2,614   Skipped: 224

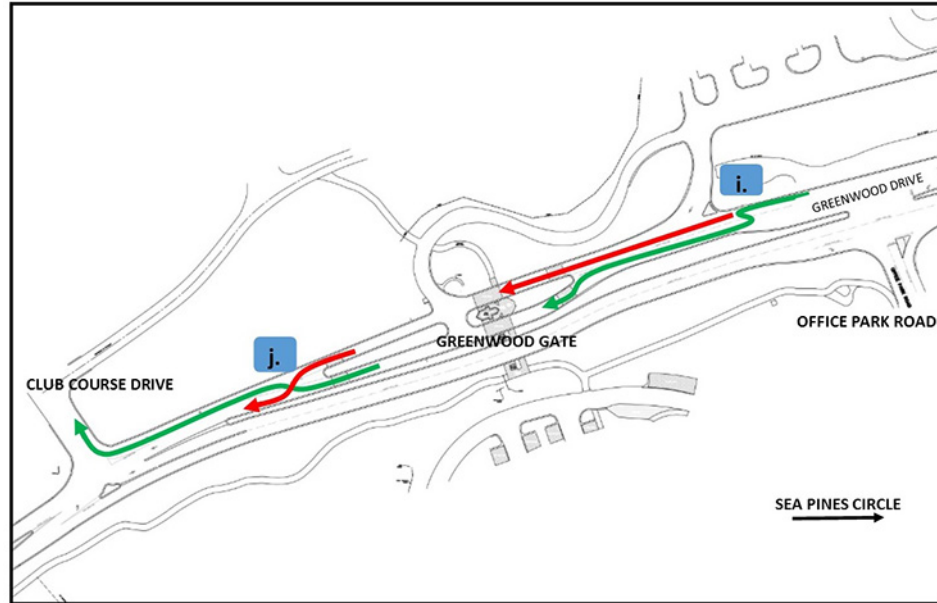

## Q11: Please continue to indicate your personal level of concern for the following traffic situations related to your inbound drive from Sea Pines Circle through the Greenwood Gate.

Answered: 2,614 Skipped: 224

	Extremely concerned	Moderately concerned	Somewhat concerned	Slightly concerned	Not at all concerned	Total	Weighted Average
i. Excessive back up in the right lane causes you to use the left lane when you're attempting to enter into Club Course Drive.	16.3%	18.5%	15.5%	17.7%	32.0%	2608	2.69
j. Difficulty turning right onto Club Course Drive after opting to use the left lane	18.4%	18.5%	14.2%	18.1%	30.9%	2603	2.76
						Answers	2614
						Skipped	224

## Q11: Please continue to indicate your personal level of concern for the following traffic situations related to your inbound drive from Sea Pines Circle through the Greenwood Gate.

Answered: 2,614 Skipped: 224

i. Excessive back up in the right lane causes you to use the left lane when you're attempting to enter into Club Course Drive.

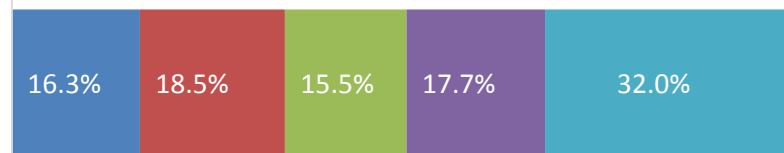

j. Difficulty turning right onto Club Course Drive after opting to use the left lane

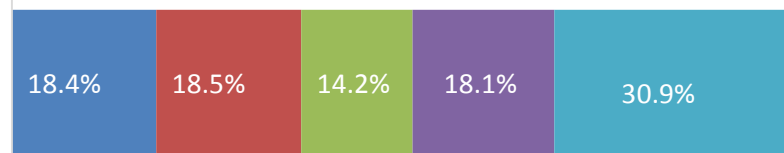

**Q12: Please continue to indicate your personal level of concern for the following traffic situation related to your inbound drive from Sea Pines Circle through the Greenwood Gate.**

Answered: 2,622 Skipped: 216

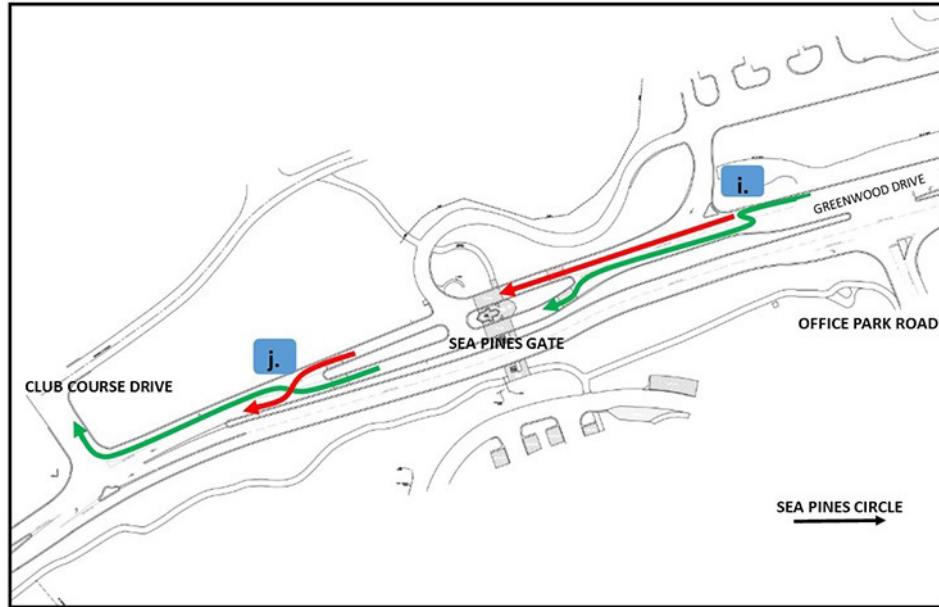

## Q12: Please continue to indicate your personal level of concern for the following traffic situation related to your inbound drive from Sea Pines Circle through the Greenwood Gate.

Answered: 2,622 Skipped: 216

	Extremely concerned	Moderately concerned	Somewhat concerned	Slightly concerned	Not at all concerned	Total	Weighted Average
k. After you enter the gate in the left lane, vehicles who entered via the right lane merge into your lane of travel.	27.5%	30.6%	19.3%	15.4%	7.3%	2622	3.56
						Answered	2622
						Skipped	216



## Q12: Please continue to indicate your personal level of concern for the following traffic situation related to your inbound drive from Sea Pines Circle through the Greenwood Gate.

Answered: 2,622 Skipped: 216

k. After you enter the gate in the left lane, vehicles who entered via the right lane merge into your lane of travel.

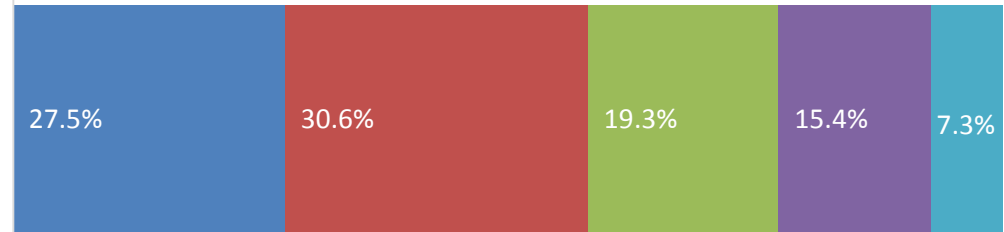

**Q13: Please continue to indicate your personal level of concern for the following traffic situations related to your inbound drive from Sea Pines Circle to the Greenwood Gate.**

Answered: 2,616 Skipped: 222

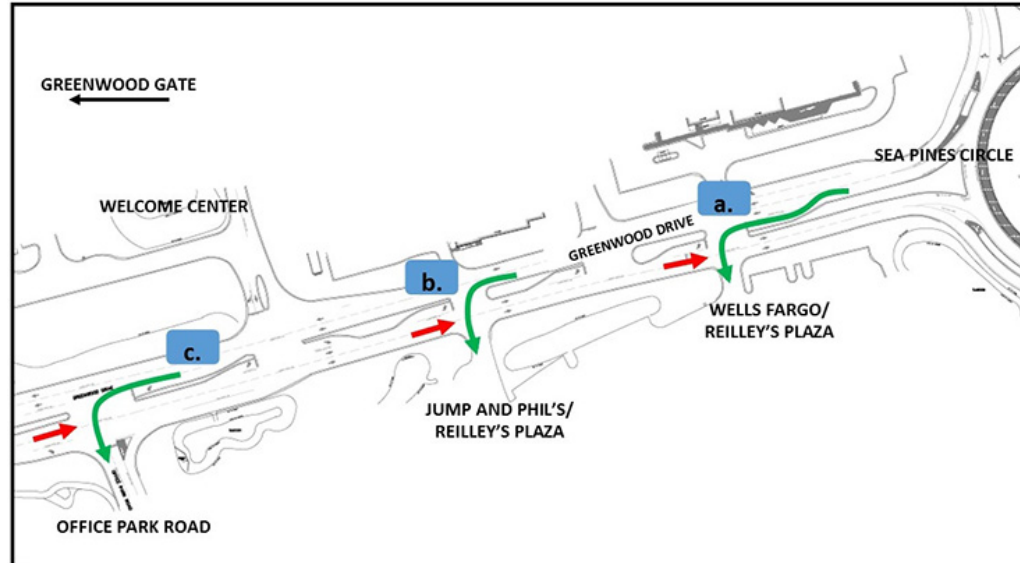

## Q13: Please continue to indicate your personal level of concern for the following traffic situations related to your inbound drive from Sea Pines Circle to the Greenwood Gate.

Answered: 2,616 Skipped: 222

	Extremely concerned	Moderately concerned	Somewhat concerned	Slightly concerned	Not at all concerned	Total	Weighted Average
a. Difficulty turning left into Wells Fargo/Reilley's Plaza (Note- You have a turn lane here.)	17.4%	21.7%	20.2%	20.3%	20.4%	2607	2.95
b. Difficulty turning left into Jump and Phil's/Reilley's Plaza (Note- You do NOT have a turn lane here.)	24.4%	24.9%	19.1%	17.2%	14.5%	2604	3.27
c. Difficulty turning left into Office Park Road (Note- You have a turn lane here.)	21.1%	27.4%	20.2%	17.0%	14.4%	2605	3.24
						Answered	2616
						Skipped	222

## Q13: Please continue to indicate your personal level of concern for the following traffic situations related to your inbound drive from Sea Pines Circle to the Greenwood Gate.

Answered: 2,616 Skipped: 222

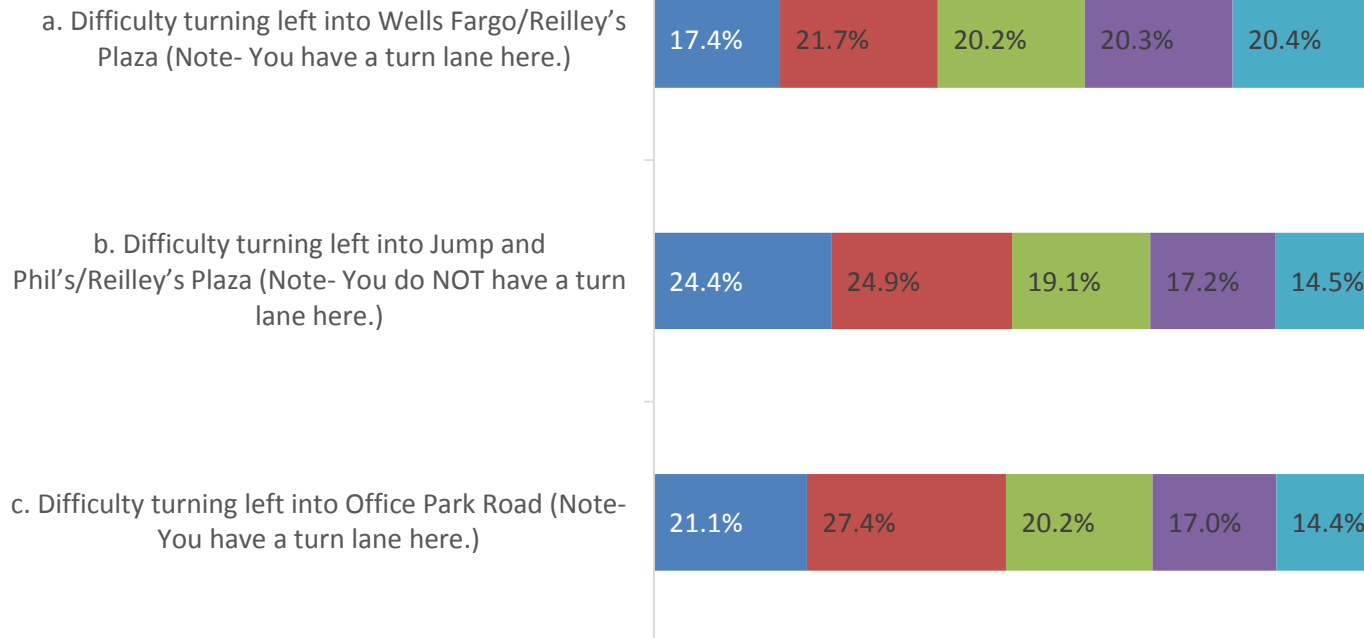

## Q14: In general, when do you experience the worst traffic conditions when traveling inbound on Greenwood Drive (from the Sea Pines Circle towards Greenwood Gate)?

Answered: 2,434 Skipped: 404

	Morning (7AM - 11AM)	Lunchtime (11AM - 2PM)	Afternoon (2PM - 6PM)	Total
Monday	26.8%	36.3%	59.9%	1956
Tuesday	24.5%	37.0%	60.5%	1921
Wednesday	24.4%	37.1%	61.1%	1923
Thursday	23.9%	37.2%	62.5%	1949
Friday	22.1%	36.7%	70.7%	2150
Saturday	17.5%	41.2%	81.0%	2303
Sunday	12.0%	42.4%	68.1%	1594
			Answered	2434
			Skipped	404

## Q14: In general, when do you experience the worst traffic conditions when traveling inbound on Greenwood Drive (from the Sea Pines Circle towards Greenwood Gate)?

Answered: 2,434 Skipped: 404

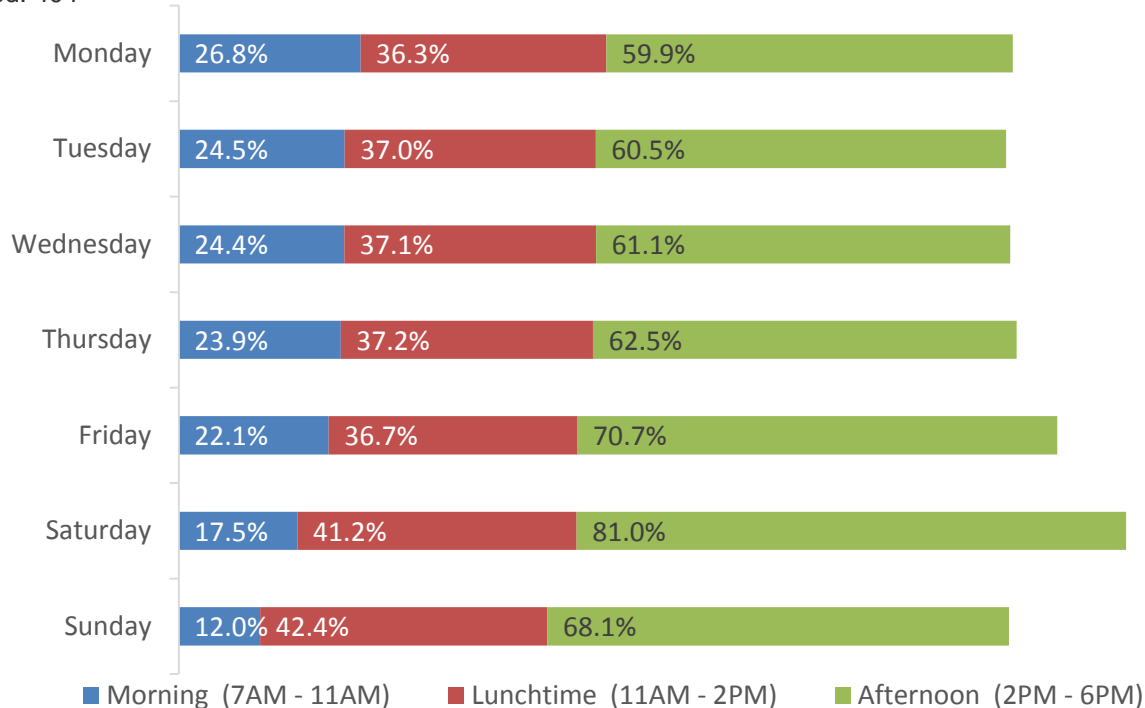

**Q15: Please indicate your personal level of concern for the following traffic situation related to this intersection at Club Course Drive and Greenwood Drive.**

Answered: 2,612 Skipped: 226

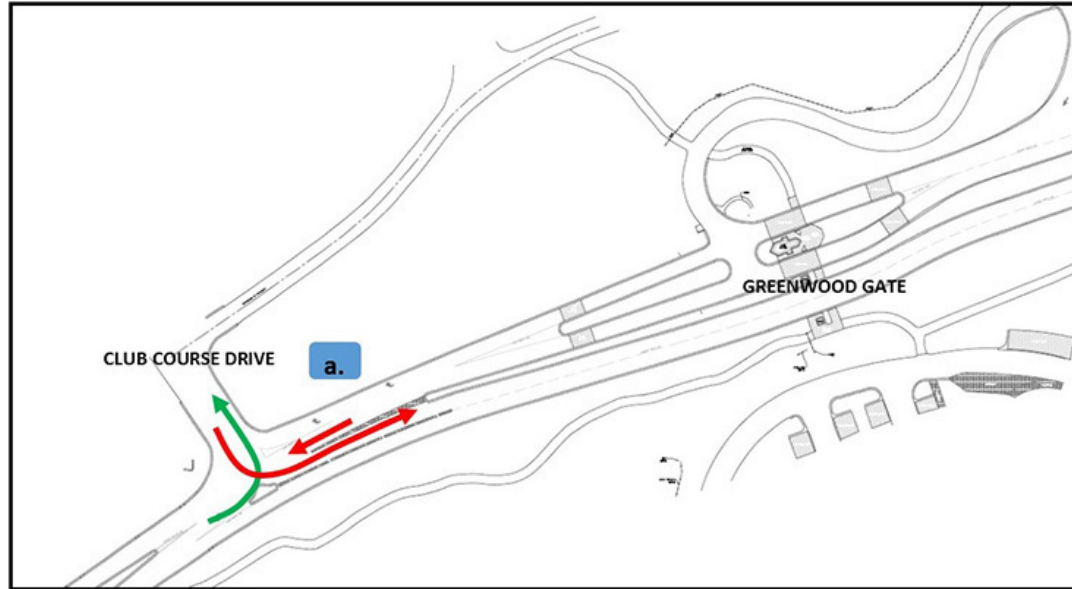

## Q15: Please indicate your personal level of concern for the following traffic situation related to this intersection at Club Course Drive and Greenwood Drive.

Answered: 2,612 Skipped: 226

	Extremely concerned	Moderately concerned	Somewhat concerned	Slightly concerned	Not at all concerned	Total	Weighted Average
a. Difficulty when turning left ONTO Club Course Drive from Greenwood Drive.	12.4%	19.9%	17.3%	19.9%	30.5%	2612	2.64
						Answered	2612
						Skipped	226



## Q15: Please indicate your personal level of concern for the following traffic situation related to this intersection at Club Course Drive and Greenwood Drive.

Answered: 2,612 Skipped: 226

a. Difficulty when turning left ONTO Club Course Drive from Greenwood Drive.

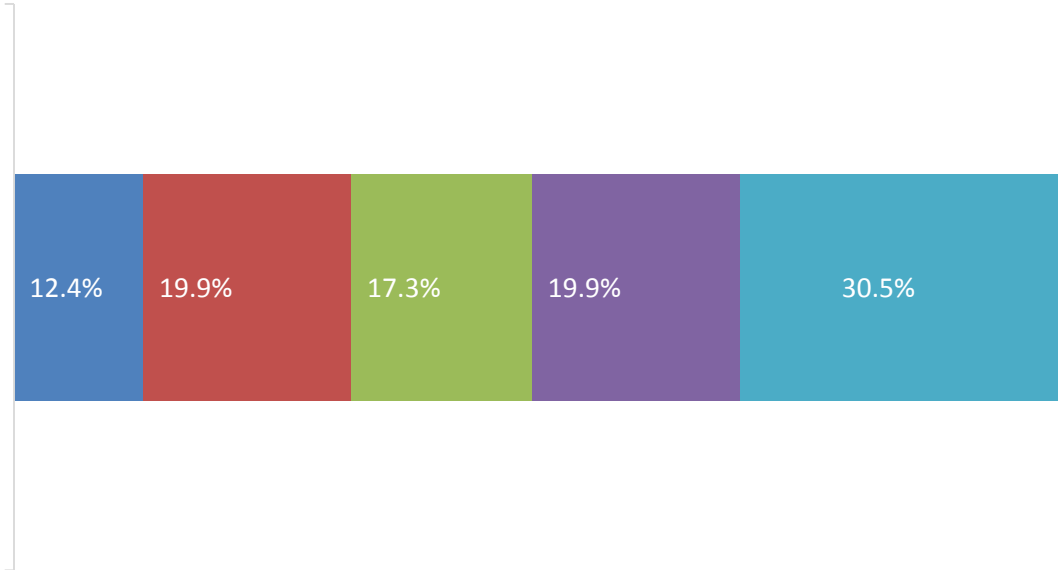

**Q16: These next sets of questions address traffic related situations associated with your outbound drive headed towards Sea Pines Circle. Please indicate your personal level of concern for each of the following questions.**

Answered: 2,592 Skipped: 246

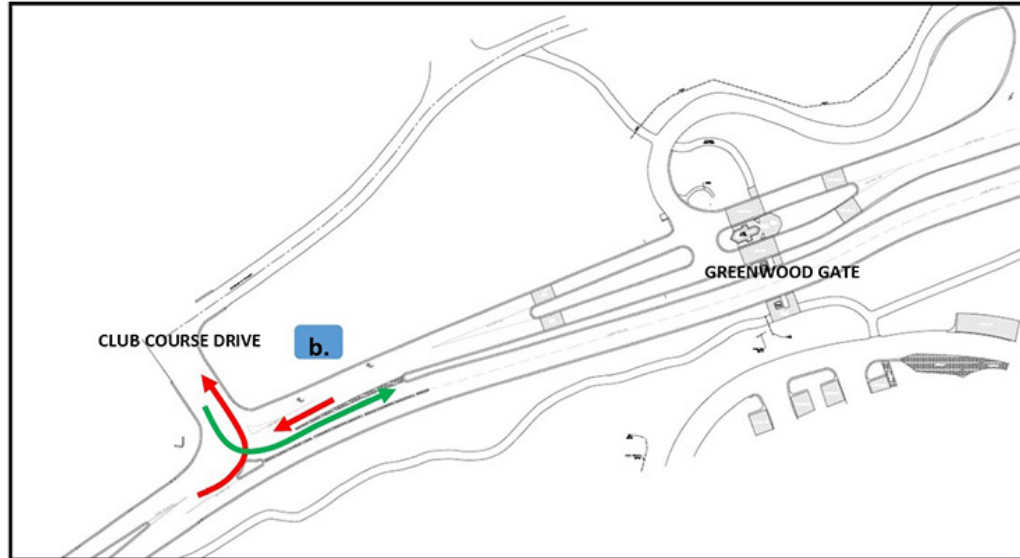

**Q16: These next sets of questions address traffic related situations associated with your outbound drive headed towards Sea Pines Circle. Please indicate your personal level of concern for each of the following questions.**

Answered: 2,592 Skipped: 246

	Extremely concerned	Moderately concerned	Somewhat concerned	Slightly concerned	Not at all concerned	Total	Weighted Average
b. Difficulty when turning left FROM Club Course Drive onto Greenwood Drive.	19.7%	20.4%	15.9%	16.4%	27.7%	2592	2.88
						Answered Skipped	2592 246

**Q16: These next sets of questions address traffic related situations associated with your outbound drive headed towards Sea Pines Circle. Please indicate your personal level of concern for each of the following questions.**

Answered: 2,592 Skipped: 246

b. Difficulty when turning left FROM Club Course Drive onto Greenwood Drive.

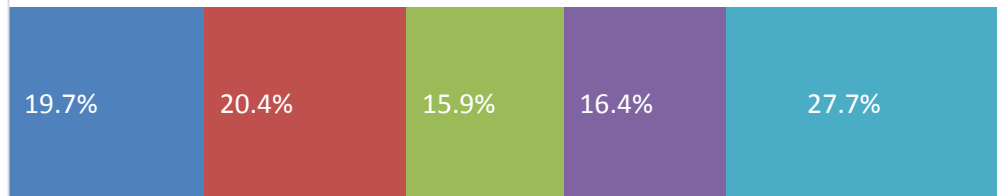

**Q17: Please continue to indicate your personal level of concern for the following traffic situation related to your outbound drive from the Greenwood Gate towards Sea Pines Circle.**

Answered: 2,610 Skipped: 228

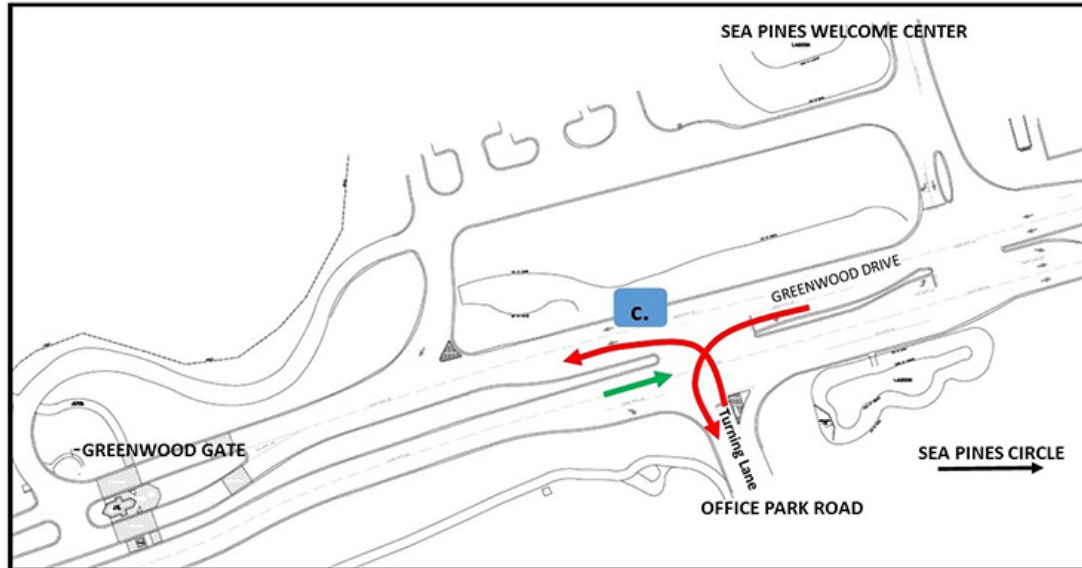

## Q17: Please continue to indicate your personal level of concern for the following traffic situation related to your outbound drive from the Greenwood Gate towards Sea Pines Circle.

Answered: 2,610 Skipped: 228

	Extremely concerned	Moderately concerned	Somewhat concerned	Slightly concerned	Not at all concerned	Total	Weighted Average
c. Vehicles turning left onto or out of Office Park Road (across your lane of travel).	41.0%	27.5%	15.5%	10.7%	5.3%	2610	3.88
						Answered	2610
						Skipped	228

## Q17: Please continue to indicate your personal level of concern for the following traffic situation related to your outbound drive from the Greenwood Gate towards Sea Pines Circle.

Answered: 2,610 Skipped: 228

c. Vehicles turning left onto or out of Office Park Road (across your lane of travel).

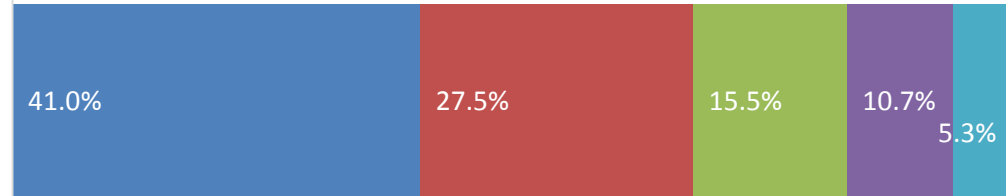

**Q18: Please continue to indicate your personal level of concern for the following traffic situation related to your outbound drive from the Greenwood Gate towards Sea Pines Circle.**

Answered: 2,607   Skipped: 231





## Q18: Please continue to indicate your personal level of concern for the following traffic situation related to your outbound drive from the Greenwood Gate towards Sea Pines Circle.

Answered: 2,607 Skipped: 231

	Extremely concerned	Moderately concerned	Somewhat concerned	Slightly concerned	Not at all concerned	Total	Weighted Average
d. Vehicles entering your lane of travel as they attempt to turn left out of the Sea Pines Welcome Center.	16.2%	26.2%	22.9%	21.6%	13.2%	2607	3.11
						Answered	2607
						Skipped	231

## Q18: Please continue to indicate your personal level of concern for the following traffic situation related to your outbound drive from the Greenwood Gate towards Sea Pines Circle.

Answered: 2,607 Skipped: 231

d. Vehicles entering your lane of travel as they attempt to turn left out of the Sea Pines Welcome Center.

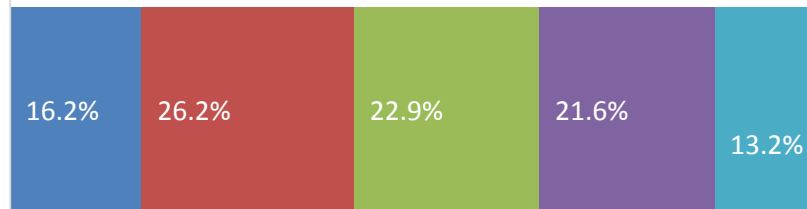

**Q19: Please continue to indicate your personal level of concern for the following traffic situations related to your outbound drive from the Greenwood Gate towards Sea Pines Circle.**

Answered: 2,614 Skipped: 224

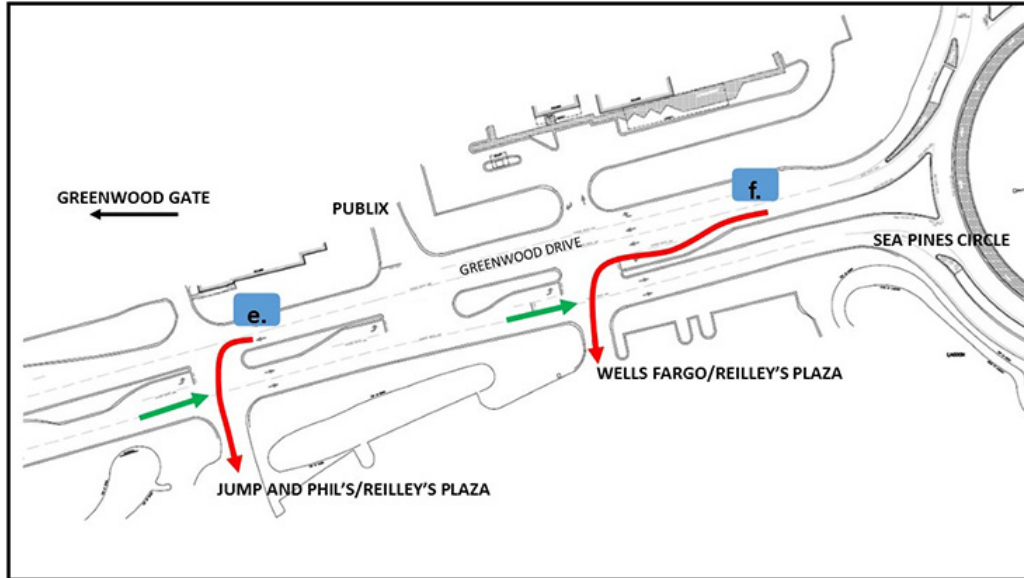

## Q19: Please continue to indicate your personal level of concern for the following traffic situations related to your outbound drive from the Greenwood Gate towards Sea Pines Circle.

Answered: 2,614 Skipped: 224

	Extremely concerned	Moderately concerned	Somewhat concerned	Slightly concerned	Not at all concerned	Total	Weighted Average
e. Inbound vehicles turning left (across your lane of travel) into Jump and Phil's/Reilley's Plaza.	25.6%	28.6%	20.0%	18.2%	7.5%	2600	3.47
f. Inbound vehicles turning left (across your lane of travel) into Wells Fargo/Reilley's Plaza.	30.3%	26.0%	19.0%	17.2%	7.5%	2584	3.54
						Answered	2614
						Skipped	224

## Q19: Please continue to indicate your personal level of concern for the following traffic situations related to your outbound drive from the Greenwood Gate towards Sea Pines Circle.

Answered: 2,614 Skipped: 224

e. Inbound vehicles turning left (across your lane of travel) into Jump and Phil's/Reilley's Plaza.



f. Inbound vehicles turning left (across your lane of travel) into Wells Fargo/Reilley's Plaza.

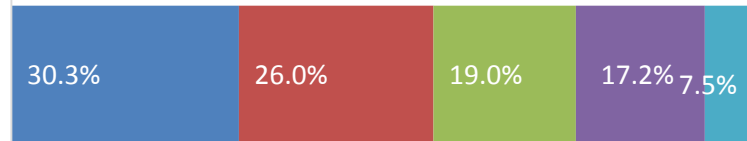

**Q20: Please continue to indicate your personal level of concern for the following traffic situation related to your outbound drive from the Greenwood Gate towards Sea Pines Circle.**

Answered: 2,607   Skipped: 231

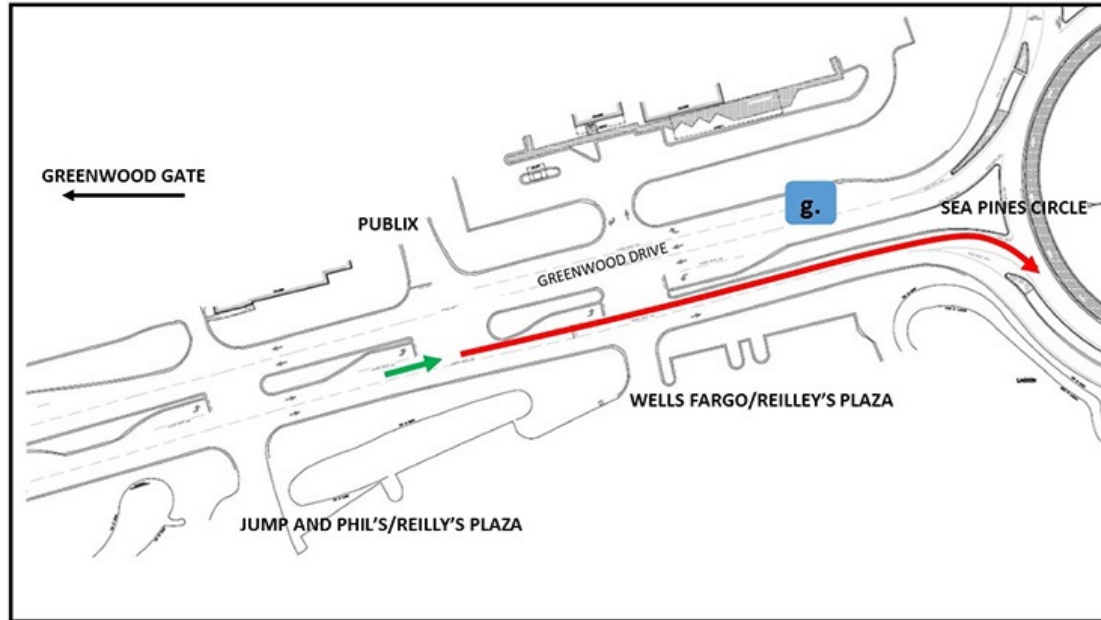

## Q20: Please continue to indicate your personal level of concern for the following traffic situation related to your outbound drive from the Greenwood Gate towards Sea Pines Circle.

Answered: 2,607 Skipped: 231

	Extremely concerned	Moderately concerned	Somewhat concerned	Slightly concerned	Not at all concerned	Total	Weighted Average
g. Delays due to excessive back up of traffic attempting to enter the Sea Pines Circle.	62.0%	22.7%	8.6%	4.5%	2.2%	2607	4.38
						Answered	2607
						Skipped	231

**Q20: Please continue to indicate your personal level of concern for the following traffic situation related to your outbound drive from the Greenwood Gate towards Sea Pines Circle.**

Answered: 2,607 Skipped: 231

g. Delays due to excessive back up of traffic attempting to enter the Sea Pines Circle.

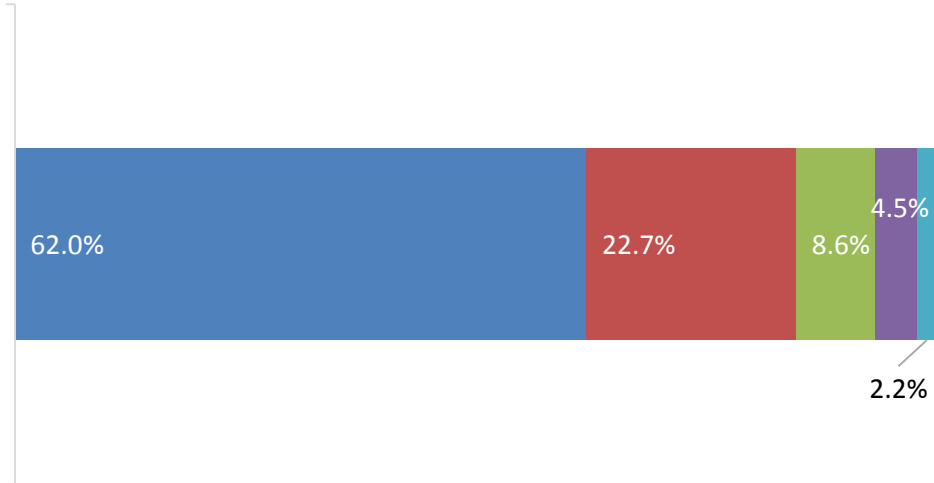



**Q21: Please continue to indicate your personal level of concern for the following traffic situations related to your outbound drive from the Greenwood Gate towards Sea Pines Circle.**

Answered: 2,612   Skipped: 226

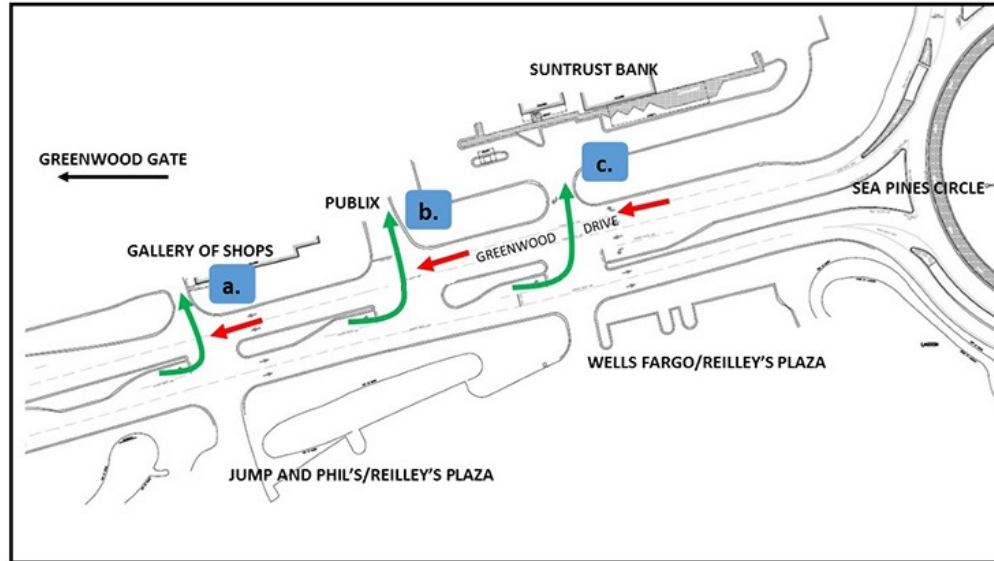

## Q21: Please continue to indicate your personal level of concern for the following traffic situations related to your outbound drive from the Greenwood Gate towards Sea Pines Circle.

Answered: 2,612 Skipped: 226

	Extremely concerned	Moderately concerned	Somewhat concerned	Slightly concerned	Not at all concerned	Total	Weighted Average
a. Difficulty turning left into the old Gallery of Shops parking lot (Note- You have a turn lane here.)	8.0%	21.4%	24.2%	24.9%	21.6%	2599	2.69
b. Difficulty turning left into Publix (Note- You have a turn lane here.)	13.9%	28.5%	24.2%	21.0%	12.4%	2604	3.11
c. Difficulty turning left into SunTrust Bank parking lot (Note- You have a turn lane here.)	8.3%	18.6%	21.7%	22.3%	29.1%	2584	2.55
						Answered	2612
						Skipped	226

## Q21: Please continue to indicate your personal level of concern for the following traffic situations related to your outbound drive from the Greenwood Gate towards Sea Pines Circle.

Answered: 2,612 Skipped: 226

a. Difficulty turning left into the old Gallery of Shops parking lot (Note- You have a turn lane here.)



b. Difficulty turning left into Publix (Note- You have a turn lane here.)

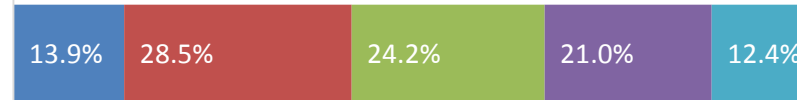

c. Difficulty turning left into SunTrust Bank parking lot (Note- You have a turn lane here.)



## Q22: In general, when do you experience the worst traffic conditions when traveling outbound on Greenwood Drive (from the Greenwood Gate towards Sea Pines Circle)?

Answered: 2,420 Skipped: 418

	Morning (7AM - 11AM)	Lunchtime (11AM - 2 PM)	Afternoon (2PM - 6PM)	Total
Monday	24.7%	51.1%	61.2%	2142
Tuesday	23.2%	51.7%	61.7%	2128
Wednesday	23.0%	52.3%	61.5%	2138
Thursday	22.7%	52.0%	63.4%	2156
Friday	23.5%	51.7%	68.0%	2270
Saturday	37.2%	50.1%	60.0%	2152
Sunday	20.2%	48.2%	61.7%	1601
			Answered	2420
			Skipped	418

## Q22: In general, when do you experience the worst traffic conditions when traveling outbound on Greenwood Drive (from the Greenwood Gate towards Sea Pines Circle)?

Answered: 2,420 Skipped: 418

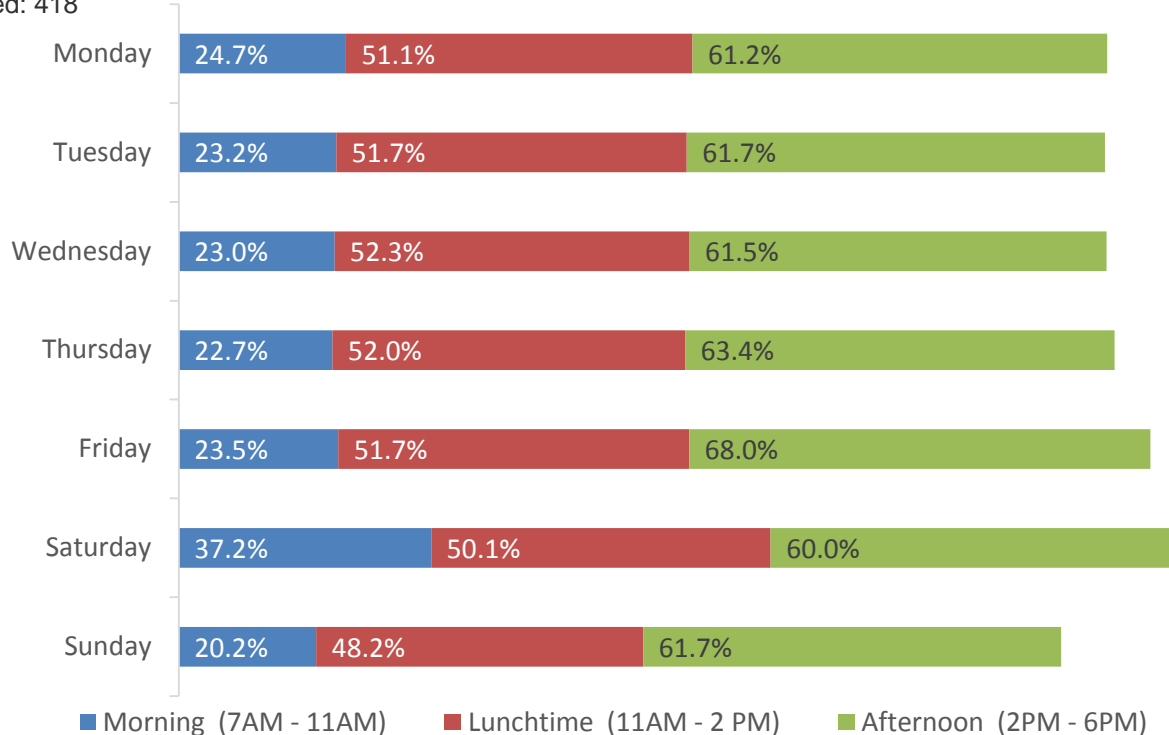

**Q23: The next set of questions are related to Greenwood Drive between the Greenwood Gate and the Sea Pines Circle, but are not inbound or outbound specific. Please indicate your level of concern for each of the following issues.**

Answered: 2,588 Skipped: 250

	Extremely concerned	Moderately concerned	Somewhat concerned	Slightly concerned	Not at all concerned	Total	Weighted Average
a. The level of congestion in this area	51.5%	27.7%	13.0%	5.0%	2.8%	2570	4.2
b. Pedestrian/bicyclist crossings specifically at the Greenwood Gate crosswalk.	20.1%	21.9%	21.4%	20.7%	15.9%	2578	3.1
c. Pedestrian/bicyclist crossings the roadway in the area between the Greenwood Gate and the Sea Pines Circle.	33.7%	22.3%	18.0%	16.2%	9.8%	2583	3.54
						Answered	2588
						Skipped	250

**Q23: The next set of questions are related to Greenwood Drive between the Greenwood Gate and the Sea Pines Circle, but are not inbound or outbound specific. Please indicate your level of concern for each of the following issues.**

Answered: 2,588 Skipped: 250

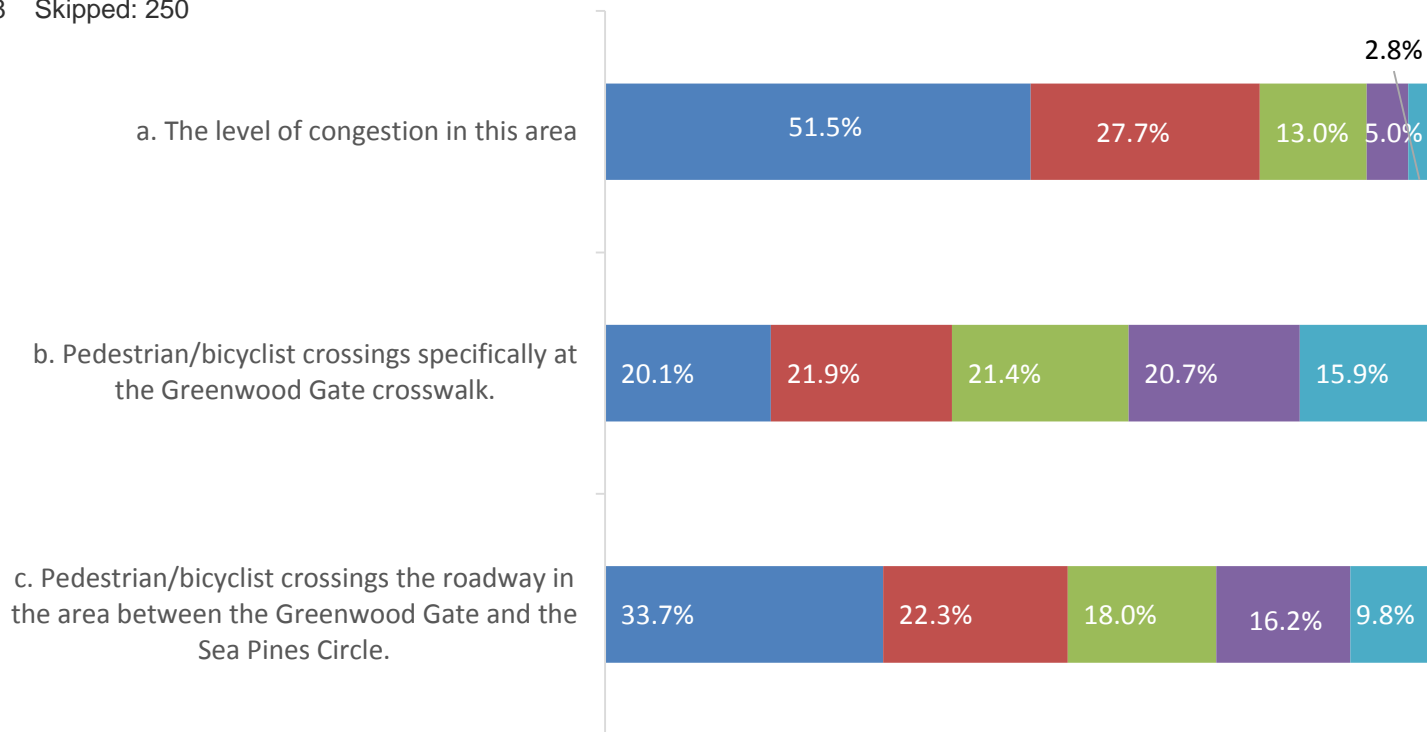

## Q24: Do you feel you also have the knowledge to answer traffic related questions about the Ocean Gate area of Sea Pines Plantation?

Answered: 2,625 Skipped: 213

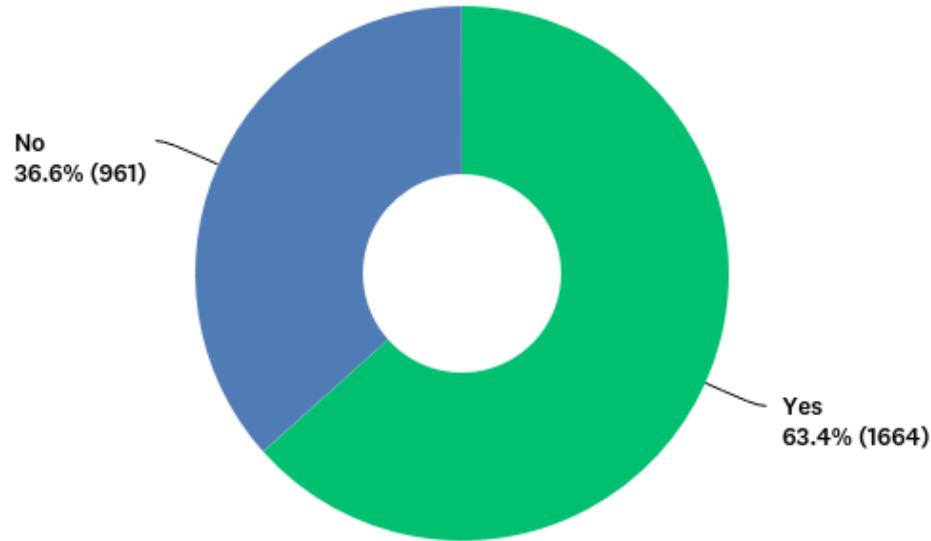



## Q25: Please estimate how often you use the Ocean Gate?

Answered: 1,712 Skipped: 1,126

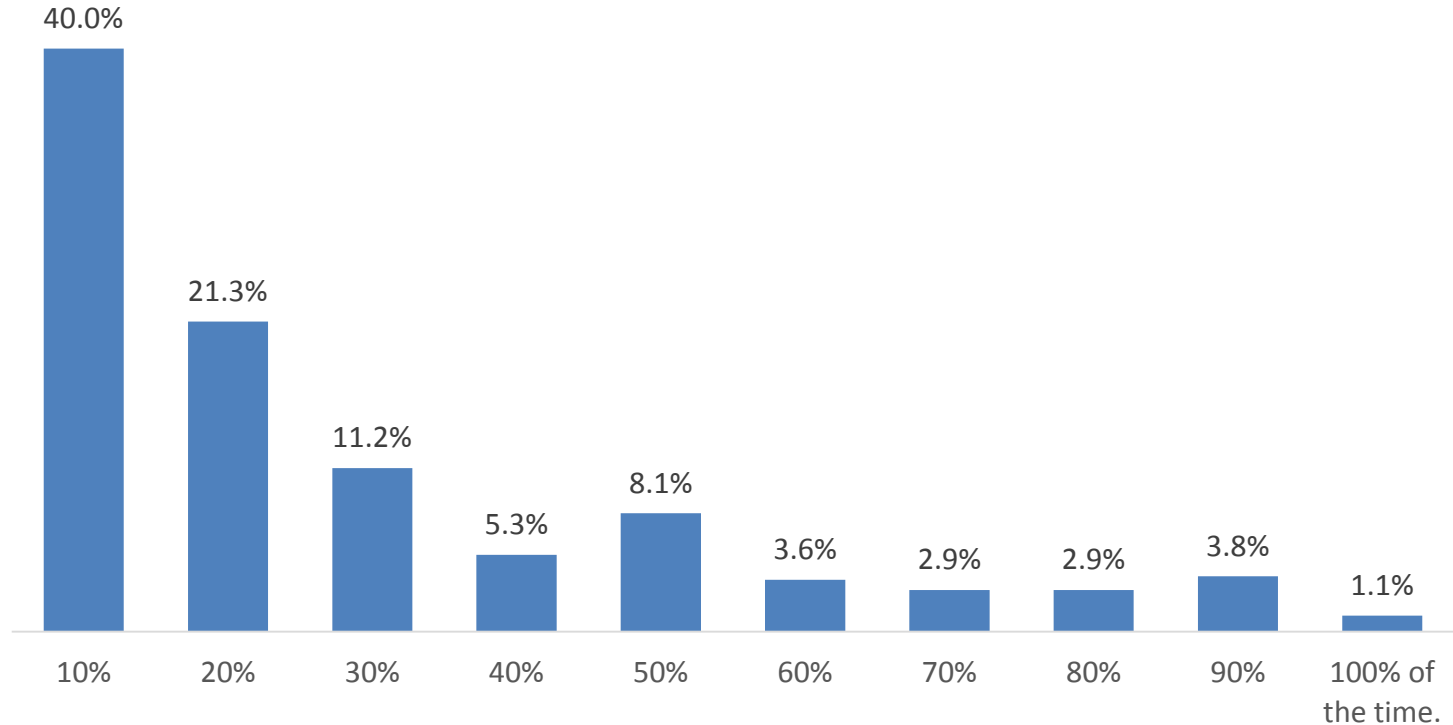

**Q26: Please indicate your personal level of concern for the following traffic situation related to your inbound drive towards the Ocean Gate of Sea Pines Plantation.**

Answered: 1,686   Skipped: 1,152

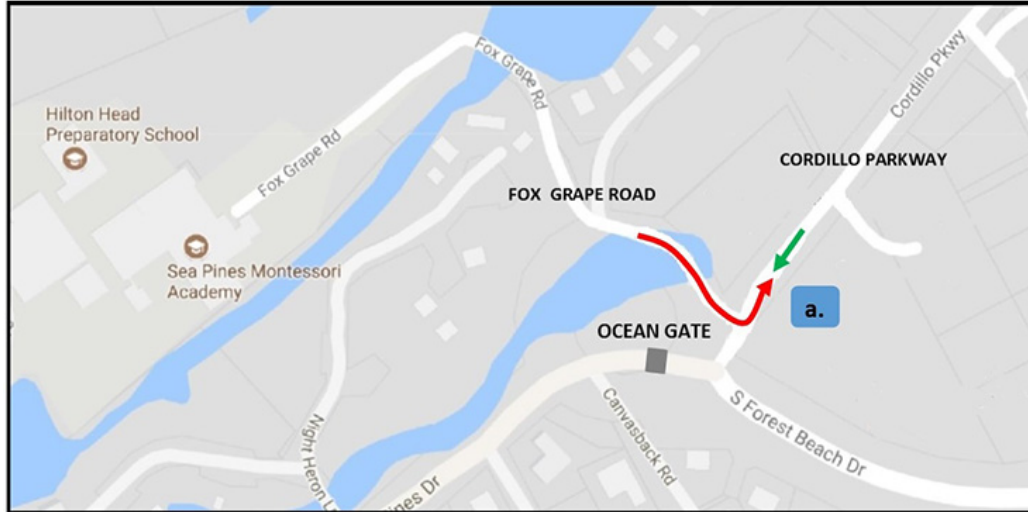

## Q26: Please indicate your personal level of concern for the following traffic situation related to your inbound drive towards the Ocean Gate of Sea Pines Plantation.

Answered: 1,686 Skipped: 1,152

	Extremely concerned	Moderately concerned	Somewhat concerned	Slightly concerned	Not at all concerned	Total	Weighted Average
a. When driving on Cordillo Parkway, vehicles turning left (across your lane of travel) when exiting Fox Grape Road.	4.0%	14.2%	20.9%	29.7%	31.2%	1686	2.3
						Answered	1686
						Skipped	1152

## Q26: Please indicate your personal level of concern for the following traffic situation related to your inbound drive towards the Ocean Gate of Sea Pines Plantation.

Answered: 1,686 Skipped: 1,152

a. When driving on Cordillo Parkway, vehicles turning left (across your lane of travel) when exiting Fox Grape Road.

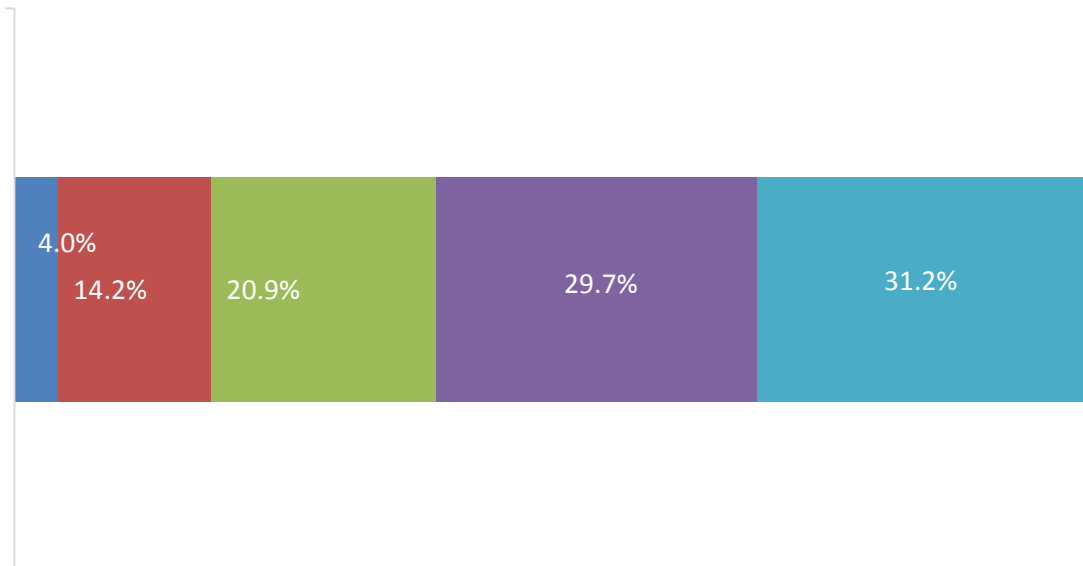

**Q27: Please continue to indicate your personal level of concern for the following traffic situation related to your inbound drive towards the Ocean Gate of Sea Pines Plantation.**

Answered: 1,679   Skipped: 1,159



## Q27: Please continue to indicate your personal level of concern for the following traffic situation related to your inbound drive towards the Ocean Gate of Sea Pines Plantation.

Answered: 1,679 Skipped: 1,159

	Extremely concerned	Moderately concerned	Somewhat concerned	Slightly concerned	Not at all concerned	Total	Weighted Average
b. When traveling on South Forest Beach Drive, outbound vehicles exiting Sea Pines turn left (across your lane of travel) onto Cordillo Parkway	5.6%	20.8%	23.5%	28.7%	21.4%	1679	2.6
						Answered	1679
						Skipped	1159

## Q27: Please continue to indicate your personal level of concern for the following traffic situation related to your inbound drive towards the Ocean Gate of Sea Pines Plantation.

Answered: 1,679 Skipped: 1,159

b. When traveling on South Forest Beach Drive, outbound vehicles exiting Sea Pines turn left (across your lane of travel) onto Cordillo Parkway



**Q28: Please continue to indicate your personal level of concern for the following traffic situation related to your inbound drive towards the Ocean Gate of Sea Pines Plantation.**

Answered: 1,678   Skipped: 1,160

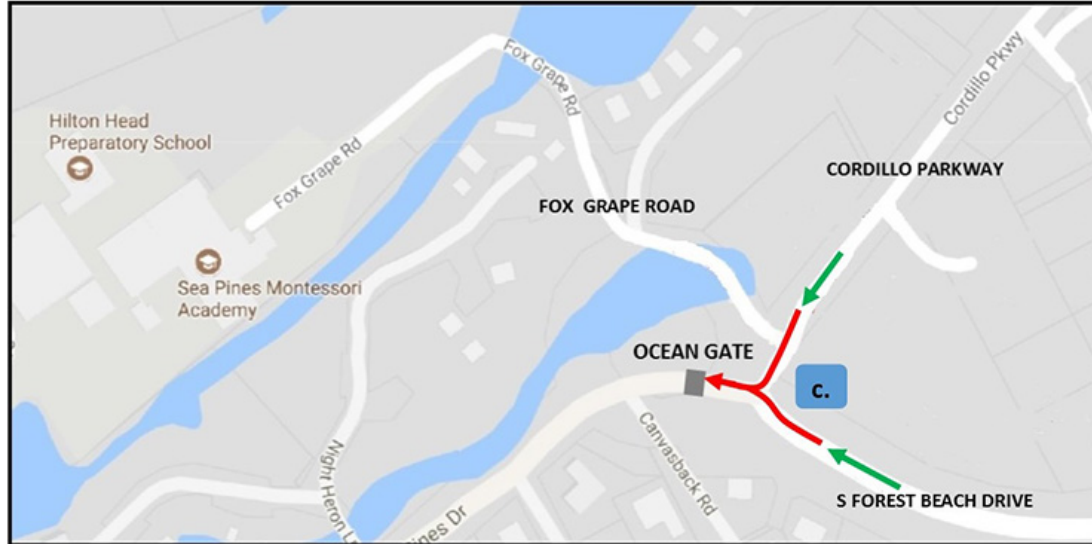



## Q28: Please continue to indicate your personal level of concern for the following traffic situation related to your inbound drive towards the Ocean Gate of Sea Pines Plantation.

Answered: 1,678 Skipped: 1,160

	Extremely concerned	Moderately concerned	Somewhat concerned	Slightly concerned	Not at all concerned	Total	Weighted Average
c. Vehicles waiting to enter the Ocean Gate back up and cause congestion at the intersection of Cordillo Parkway and South Forest Beach Drive	23.0%	28.4%	21.4%	18.6%	8.6%	1678	3.38
						Answered	1678
						Skipped	1160

## Q28: Please continue to indicate your personal level of concern for the following traffic situation related to your inbound drive towards the Ocean Gate of Sea Pines Plantation.

Answered: 1,678 Skipped: 1,160

c. Vehicles waiting to enter the Ocean Gate back up and cause congestion at the intersection of Cordillo Parkway and South Forest Beach Drive

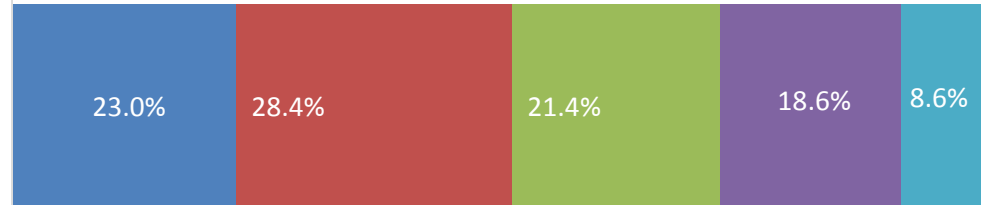

**Q29: Please continue to indicate your personal level of concern for the following traffic situation related to your inbound drive at the Ocean Gate of Sea Pines Plantation.**

Answered: 1,680   Skipped: 1,158



## Q29: Please continue to indicate your personal level of concern for the following traffic situation related to your inbound drive at the Ocean Gate of Sea Pines Plantation.

Answered: 1,680 Skipped: 1,158

	Extremely concerned	Moderately concerned	Somewhat concerned	Slightly concerned	Not at all concerned	Total	Weighted Average
d. The vehicle in front of you stops/slows down to make a U-turn around the back of the gatehouse	11.6%	19.8%	20.4%	23.0%	25.2%	1680	2.7
						Answered	1680
						Skipped	1158

## Q29: Please continue to indicate your personal level of concern for the following traffic situation related to your inbound drive at the Ocean Gate of Sea Pines Plantation.

Answered: 1,680 Skipped: 1,158

d. The vehicle in front of you stops/slows down to make a U-turn around the back of the gatehouse

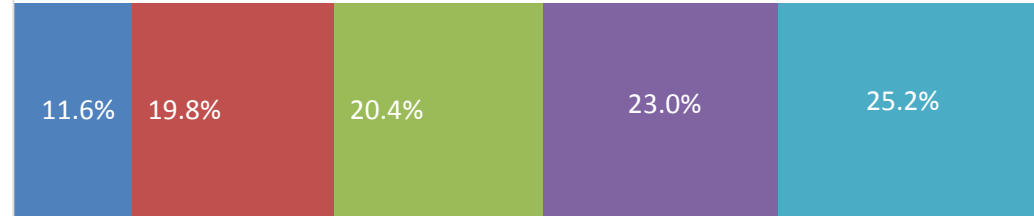

**Q30: Please continue to indicate your personal level of concern for the following traffic situation related to your inbound drive towards the Ocean Gate of Sea Pines Plantation.**

Answered: 1,677   Skipped: 1,161



## Q30: Please continue to indicate your personal level of concern for the following traffic situation related to your inbound drive towards the Ocean Gate of Sea Pines Plantation.

Answered: 1,677 Skipped: 1,161

	Extremely concerned	Moderately concerned	Somewhat concerned	Slightly concerned	Not at all concerned	Total	Weighted Average
e. Vehicles turning around prior to the Ocean Gate by making U-turns at the intersection of Cordillo Parkway and South Forest Beach Drive	16.5%	18.6%	18.6%	21.7%	24.6%	1677	2.81
						Answered	1677
						Skipped	1161

## Q30: Please continue to indicate your personal level of concern for the following traffic situation related to your inbound drive towards the Ocean Gate of Sea Pines Plantation.

Answered: 1,677 Skipped: 1,161

e. Vehicles turning around prior to the Ocean Gate by making U-turns at the intersection of Cordillo Parkway and South Forest Beach Drive

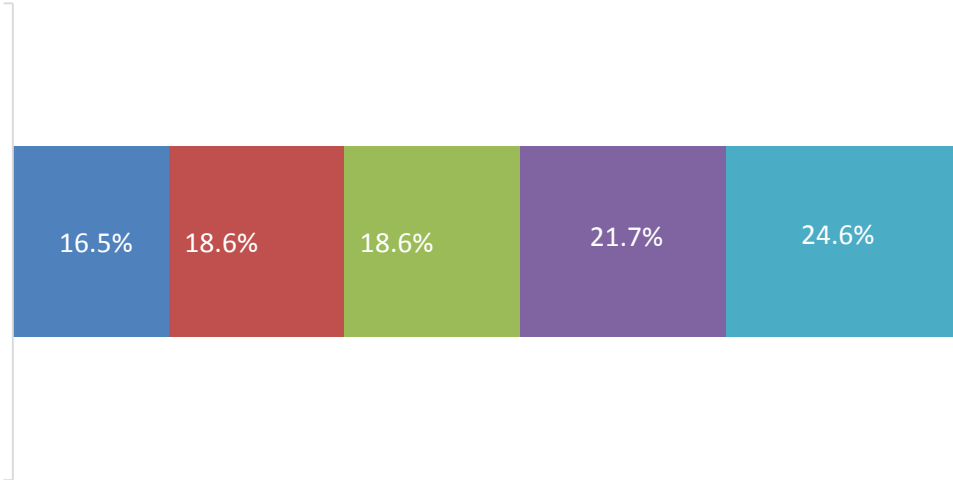



**Q31: Please indicate your personal level of concern for the following traffic situation related to your outbound drive headed out of Sea Pines Plantation via the Ocean Gate.**

Answered: 1,681   Skipped: 1,157



## Q31: Please indicate your personal level of concern for the following traffic situation related to your outbound drive headed out of Sea Pines Plantation via the Ocean Gate.

Answered: 1,681 Skipped: 1,157

	Extremely concerned	Moderately concerned	Somewhat concerned	Slightly concerned	Not at all concerned	Total	Weighted Average
a. Vehicles entering your lane of travel after making a U-turn behind the gatehouse	10.7%	17.3%	18.9%	26.7%	26.4%	1681	2.59
						Answered	1681
						Skipped	1157

## Q31: Please indicate your personal level of concern for the following traffic situation related to your outbound drive headed out of Sea Pines Plantation via the Ocean Gate.

Answered: 1,681 Skipped: 1,157

a. Vehicles entering your lane of travel after making a U-turn behind the gatehouse

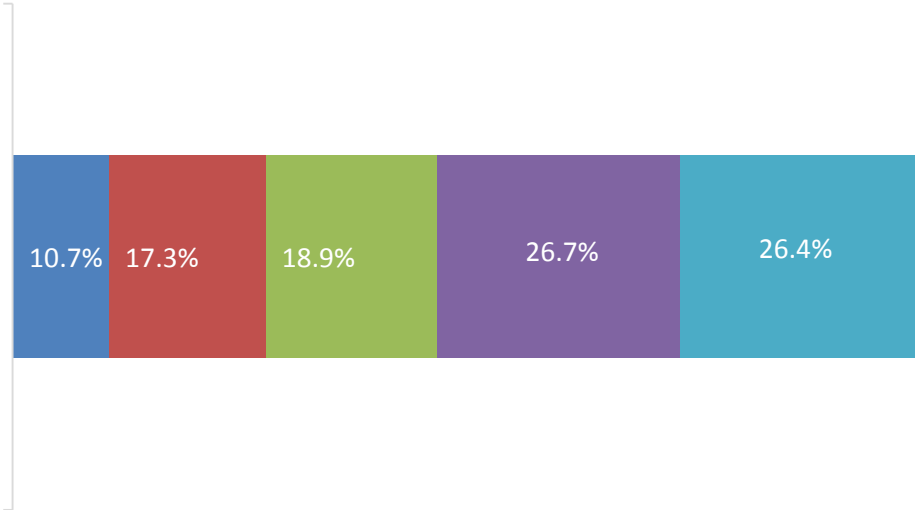

**Q32: Please indicate your personal level of concern for the following traffic situation related to your outbound drive headed out of Sea Pines Plantation via the Ocean Gate.**

Answered: 1,676 Skipped: 1,162



## Q32: Please indicate your personal level of concern for the following traffic situation related to your outbound drive headed out of Sea Pines Plantation via the Ocean Gate.

Answered: 1,676 Skipped: 1,162

	Extremely concerned	Moderately concerned	Somewhat concerned	Slightly concerned	Not at all concerned	Total	Weighted Average
b. Inbound vehicles turning around prior to the Ocean Gate by making U-turns at the intersection of Cordillo Parkway and South Forest Beach Drive	13.4%	17.8%	18.6%	25.8%	24.4%	1676	2.7
						Answered	1676
						Skipped	1162

## Q32: Please indicate your personal level of concern for the following traffic situation related to your outbound drive headed out of Sea Pines Plantation via the Ocean Gate.

Answered: 1,676 Skipped: 1,162

b. Inbound vehicles turning around prior to the Ocean Gate by making U-turns at the intersection of Cordillo Parkway and South Forest Beach Drive

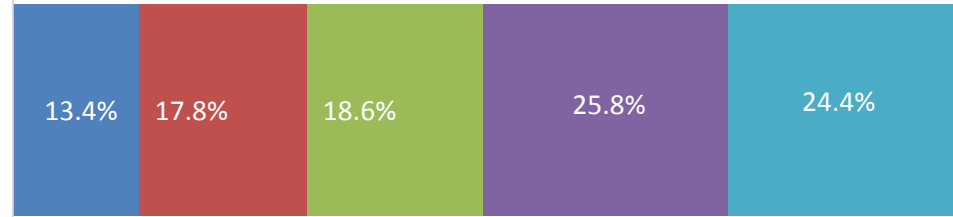

## Q33: How long have you owned or resided in Sea Pines?

Answered: 2,634 Skipped: 204

40%

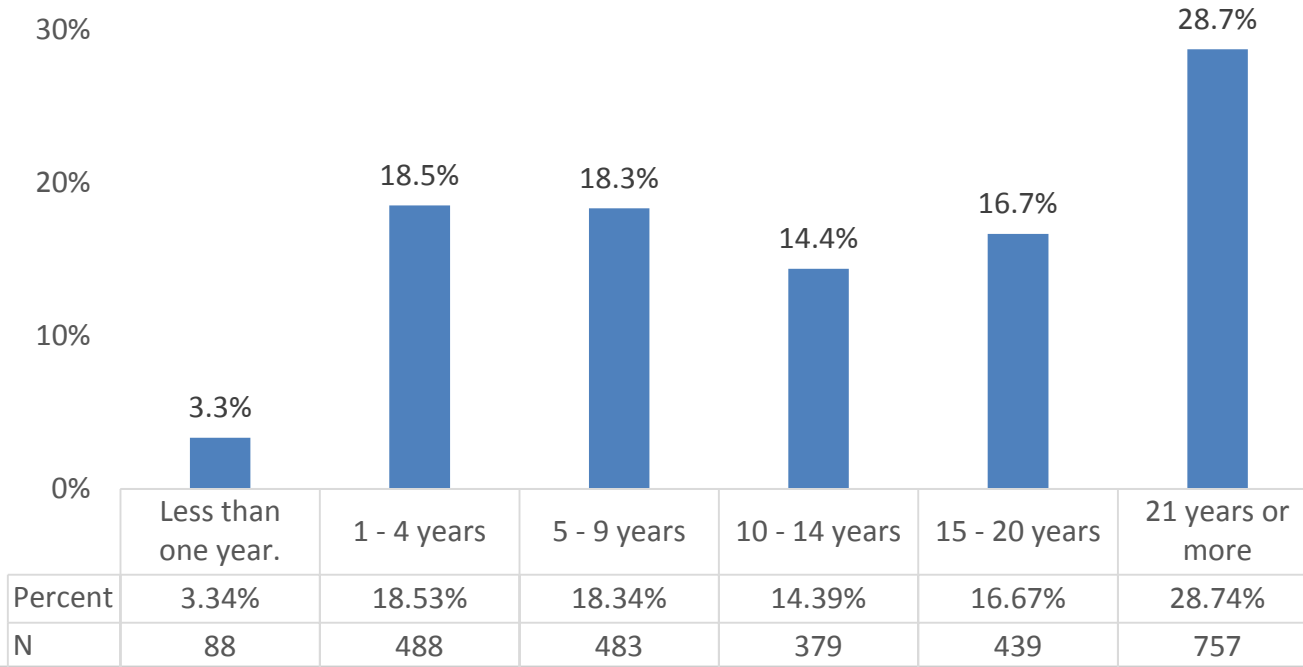

## Q34: Please indicate your gender.

Answered: 2,607 Skipped: 231

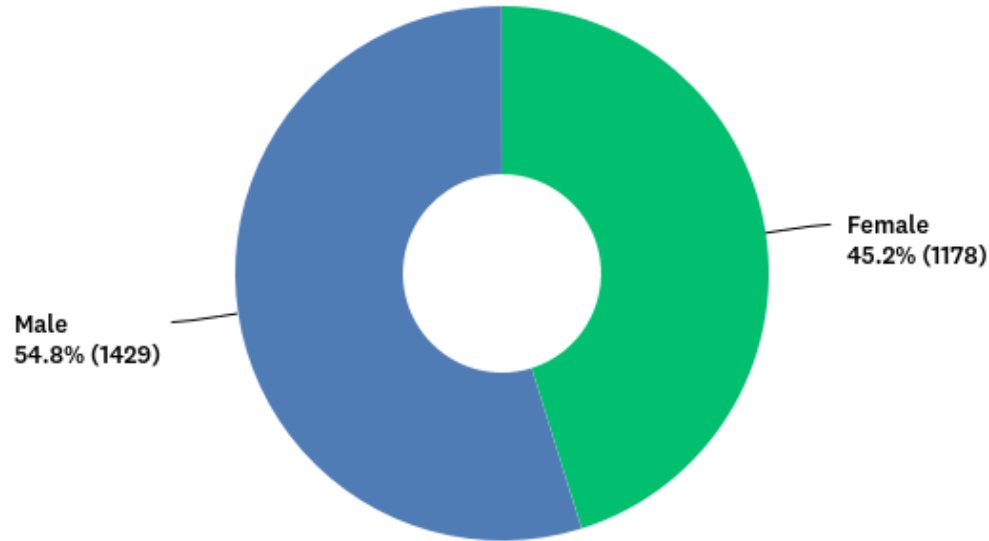



## Q35: Please indicate your age below.

Answered: 2,624 Skipped: 214

